

# K-BKR SERIE VALVE LINE

Stainless steel ball valves

**HANSA FLEX**

## Eigenschappen

|                                  |   |
|----------------------------------|---|
| <b>Werkdruk</b>                  | max. 70 bar, depending on temperature and nominal size    |
| <b>Bedrijfstemperatuur</b>       | -15 °C to +110 °C, depending on port size and temperature |
| <b>Schroefdraad beschrijving</b> | G thread acc. DIN EN ISO 228-1                            |
| <b>Afdichting</b>                | PTFE  |
| <b>Handhendel</b>                | Stainless steel 1.4301                                    |
| <b>Materiaal</b>                 | sealing: PTFE   |

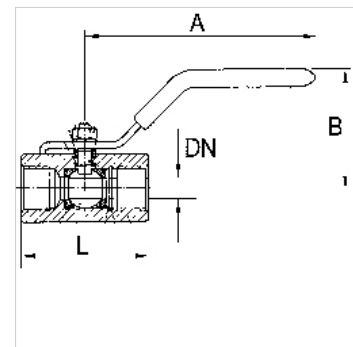

## Aanwijzing

Andere gegevens op aanvraag.

## Artikel

| Aanduiding     | DN | Schroefdraad | A<br>(mm) | B<br>(mm) | L<br>(mm) | Materiaal              |
|----------------|----|--------------|-----------|-----------|-----------|------------------------|
| K- 07 30 15 24 | 13 | 1/4          | 99,5      | 47,0      | 47,5      | Stainless steel 1.4408 |
| K- 07 30 15 25 | 13 | 3/8          | 99,5      | 47,0      | 47,5      | Stainless steel 1.4408 |
| K- 07 30 15 26 | 15 | 1/2          | 99,5      | 48,0      | 58,0      | Stainless steel 1.4408 |
| K- 07 30 15 27 | 20 | 3/4          | 126,5     | 62,0      | 65,0      | Stainless steel 1.4408 |
| K- 07 30 15 28 | 25 | 1            | 126,5     | 69,0      | 77,0      | Stainless steel 1.4408 |
| K- 07 30 15 29 | 32 | 1 1/4        | 153,0     | 81,0      | 90,0      | Stainless steel 1.4408 |
| K- 07 30 15 30 | 38 | 1 1/2        | 153,0     | 87,0      | 98,5      | Stainless steel 1.4408 |
| K- 07 30 15 31 | 50 | 2            | 192,0     | 95,0      | 122,0     | Stainless steel 1.4408 |