

K-W90 AG

Male elbows with male G thread

HANSA FLEX

Eigenschappen

Werkdruk	Dependent on operating temperature; Max. 10 bar (at 20 °C); Max. 1 bar (at 60 °C)
Vastschroefelement	Polyamide (PA)
Klemring	Polypropylene (PP)
Moer	Polypropylene (PP)

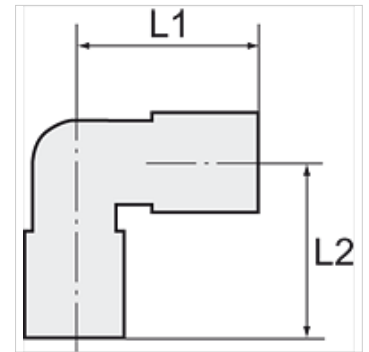

Aanwijzing

Andere gegevens op aanvraag.

Beschrijving

Manufactured from high impact-resistant, UV-stabilised engineering plastic, extremely resistant to weathering. Good chemical resistance to benzine, diesel oil, fuel oil and alkalis.
Not suitable for use with acids.

Artikel

Aanduiding	Schroefdraad	voor slang	L1 (mm)	L2 (mm)
K- 07 40 32 82	G 1/8	4 mm / 6 mm	25,0	20,0
K- 07 40 32 83	G 1/8	6 mm / 8 mm	30,0	23,0
K- 07 40 32 84	G 1/8	8 mm / 10 mm	36,0	25,0
K- 07 40 32 85	G 1/8	9 mm / 12 mm	40,0	27,0
K- 07 40 32 86	G 1/4	4 mm / 6 mm	26,0	25,0
K- 07 40 32 87	G 1/4	6 mm / 8 mm	30,0	27,0
K- 07 40 32 88	G 1/4	8 mm / 10 mm	36,0	32,0
K- 07 40 32 89	G 1/4	9 mm / 12 mm	40,0	31,0
K- 07 40 32 90	G 3/8	4 mm / 6 mm	29,0	30,0
K- 07 40 32 91	G 3/8	6 mm / 8 mm	33,0	27,0
K- 07 40 32 92	G 3/8	8 mm / 10 mm	36,0	29,0
K- 07 40 32 93	G 3/8	9 mm / 12 mm	40,0	31,0
K- 07 40 32 94	G 1/2	4 mm / 6 mm	32,0	29,0
K- 07 40 32 95	G 1/2	6 mm / 8 mm	36,0	29,0
K- 07 40 32 96	G 1/2	8 mm / 10 mm	39,0	31,0
K- 07 40 32 97	G 1/2	9 mm / 12 mm	43,0	33,0