

K-W90 AG-K ISO 7-1 3

Male elbows, conical male thread acc. to ISO 7-1

HANSA FLEX

Eigenschappen

Drukbereik Max. 60 bar

Temperatuur Max. 150 °C

Materiaal messing vernikkeld

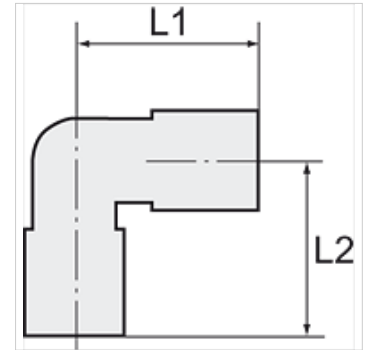
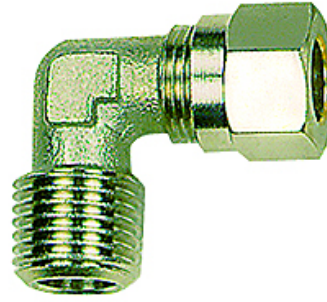

Aanwijzing

Andere gegevens op aanvraag.

Artikel

Aanduiding	Buis-buiten-Ø	Schroefdraad	L1 (mm)	L2 (mm)	SW	SW1 (mm)
K- 07 40 20 59	4 mm	R 1/8	21,0	16,0	9 mm	10
K- 07 40 20 60	6 mm	R 1/8	22,0	16,0	9 mm	12
K- 07 40 20 61	8 mm	R 1/8	24,0	17,0	11 mm	14
K- 07 40 20 62	6 mm	R 1/4	24,5	20,0	11 mm	12
K- 07 40 20 63	8 mm	R 1/4	24,0	20,0	11 mm	14
K- 07 40 20 64	10 mm	R 1/4	32,0	23,5	13 mm	19
K- 07 40 20 65	8 mm	R 3/8	27,0	24,0	13 mm	14
K- 07 40 20 66	10 mm	R 3/8	32,0	24,0	13 mm	19
K- 07 40 20 67	12 mm	R 3/8	34,5	25,5	15 mm	22
K- 07 40 19 79	10 mm	R 1/2	34,0	28,5	15 mm	19
K- 07 40 19 80	12 mm	R 1/2	34,5	28,5	15 mm	22
K- 07 40 19 81	15 mm	R 1/2	38,0	30,0	17 mm	27
K- 07 40 19 82	18 mm	R 1/2	44,0	34,0	22 mm	32