

K-3/2-BKR VARIOBLOC

Ball valves

HANSA FLEX

Eigenschappen

Omgevingstemperatuur Max. 80 °C

Werkdruk Max. 20 bar

Debietwaardemeting At P1 = 6 bar and pressure drop $\Delta p = 1$ bar

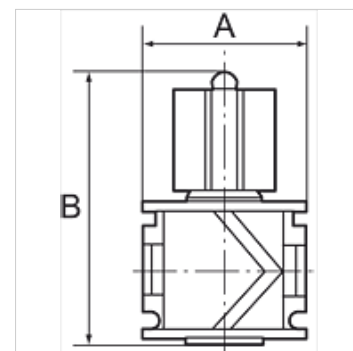

Aanwijzing

Andere gegevens op aanvraag.

Beschrijving

Used as the main shut-off element, especially for flanging onto the start of a variobloc service unit. With pressure relief and silencer. Can be locked with a standard padlock.

Artikel

| Aanduiding | Schroefdraad | Debiet (L/min) | A (mm) | B |
|----------------|--------------|----------------|--------|---------|
| K- 07 25 11 89 | G 1/4 | 4300 | 48,0 | 80,0 mm |
| K- 07 25 11 90 | G 3/8 | 4400 | 48,0 | 80,0 mm |
| K- 07 25 11 91 | G 1/2 | 9000 | 70,0 | 92,0 mm |
| K- 07 25 11 92 | G 3/4 | 11000 | 70,0 | 92,0 mm |
| K- 07 25 11 93 | G 1 | 11000 | 124,0 | 92,0 mm |