

K-VERSCHRAUBUNGEN PFA

Unions - Perfluoroalkoxy alkane (PFA)

HANSA FLEX

Eigenschappen

| | |
|----------------------------|--|
| Werkdruk | Dependent on operating temperature; Max. 10 bar (at 20 °C); Max. 1 bar (at 170 °C) |
| Bedrijfstemperatuur | Max. 200 °C |
| Materiaal | Perfluoroalkoxy alkane (PFA) |

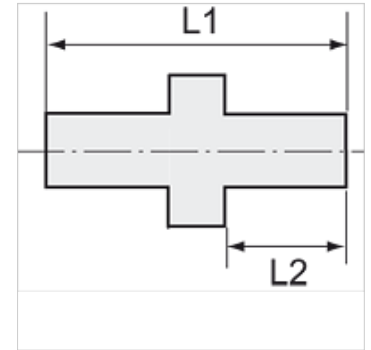
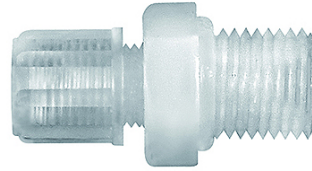

Aanwijzing

Andere gegevens op aanvraag.

Beschrijving

Perfluoroalkoxy alkane (PFA): A fluoroplastic (PTFE) with the same chemical resistance as PTFE but much stronger and suitable for temperatures up to 200°C.

Artikel

| Aanduiding | Schroefdraad | voor slang | L1 (mm) | L2 (mm) | SW |
|----------------|--------------|--------------|------------|------------|-------|
| K- 07 40 40 97 | G 1/8 | 4 mm / 6 mm | 31,5 | 8,0 | 14 mm |
| K- 07 40 40 99 | G 1/8 | 6 mm / 8 mm | 36,5 | 8,0 | 17 mm |
| K- 07 40 41 01 | G 1/8 | 8 mm / 10 mm | 40,5 | 8,0 | 19 mm |
| K- 07 40 41 04 | G 1/4 | 4 mm / 6 mm | 37,0 | 12,0 | 17 mm |
| K- 07 40 41 06 | G 1/4 | 6 mm / 8 mm | 41,0 | 12,0 | 17 mm |
| K- 07 40 41 08 | G 1/4 | 8 mm / 10 mm | 45,0 | 12,0 | 19 mm |
| K- 07 40 41 10 | G 1/4 | 9 mm / 12 mm | 48,5 | 12,0 | 22 mm |
| K- 07 40 41 12 | G 3/8 | 4 mm / 6 mm | 38,5 | 12,0 | 22 mm |
| K- 07 40 41 14 | G 3/8 | 6 mm / 8 mm | 42,5 | 12,0 | 22 mm |
| K- 07 40 41 16 | G 3/8 | 8 mm / 10 mm | 45,5 | 12,0 | 22 mm |
| K- 07 40 41 18 | G 3/8 | 9 mm / 12 mm | 49,5 | 12,0 | 22 mm |
| K- 07 40 41 20 | G 1/2 | 4 mm / 6 mm | 43,0 | 14,0 | 27 mm |
| K- 07 40 41 22 | G 1/2 | 6 mm / 8 mm | 47,0 | 14,0 | 27 mm |
| K- 07 40 41 24 | G 1/2 | 8 mm / 10 mm | 50,0 | 14,0 | 27 mm |
| K- 07 40 41 26 | G 1/2 | 9 mm / 12 mm | 54,0 | 14,0 | 27 mm |