

K-MUFFEN SK

Sockets with outer hex

HANSA FLEX

Eigenschappen

Werkdruk	10 bar
Mediumtemperatuur	max. +90 °C
Omgevingstemperatuur	Max. +90 °C
Materiaal	Brass with a bare metal surface

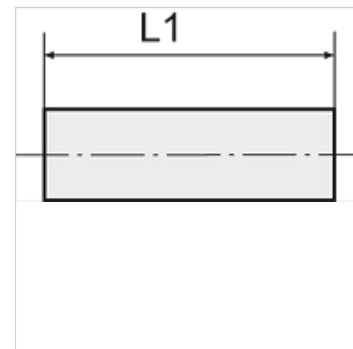
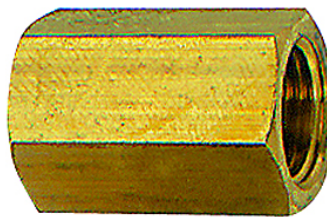

Aanwijzing

The dimensions of the standard screw fittings may change slightly during the life of the catalogue as a result of optimisation processes.
Andere gegevens op aanvraag.

Extra informatie

Further types and dimensions on request.

Artikel

Aanduiding	Schroefdraad	L1 (mm)	SW
K- 07 40 00 41	M 5	12,0	8 mm
K- 07 40 00 42	G 1/8	22,0	14 mm
K- 07 40 00 43	G 1/4	26,0	17 mm
K- 07 40 00 44	G 3/8	26,0	22 mm
K- 07 40 00 45	G 1/2	30,0	27 mm
K- 07 40 00 46	G 3/4	36,0	32 mm
K- 07 40 00 47	G 1	40,0	41 mm