

WN VA

Dwuzłączka wkręcana, kąt 90°

HANSA FLEX

Właściwości

| | |
|------------------------|---|
| Przyłącze 1 | Gwint zewnętrzny NPT |
| Rodzaj uszczelnienia 1 | uszczelnia gwint |
| Przyłącze 2 | metryczny gwint zewnętrzny cylindryczny |
| Rodzaj uszczelnienia 2 | stożek wewnętrzny 24° |
| Typ konstrukcji | wkręcana dwuzłączka gwintowana |
| Kształt | kąt 90° |
| Norma | DIN 2353 ISO 8434-1 |
| Zakres dostawy | króciec z nakrętką kołpakową i pierścieniem zacinającym |
| Materiał | stal szlachetna |

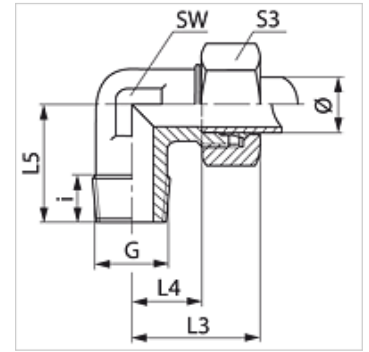

Wskazówka

Wskazówki do montażu, zabudowy, obciążalności ciśnieniowej i dopuszczalnych temperatur roboczych są zawarte w Informacjach Technicznych dwuzłączek rurowych.

Artykuł

| Oznaczenie | Typoszereg | Ciśnienie robocze bar | Średnica zewnętrzna rury Ø (mm) | G | i (mm) | L3 (mm) | L4 (mm) | L5 (mm) | SW (mm) | S3 (mm) |
|--------------------|------------|-----------------------|---------------------------------|------------------|--------|---------|---------|---------|---------|---------|
| WN 04 LL VA | LL | PN 100 | 4 | 1/8" -27 NPT | 7,0 | 21 | 11,0 | 17 | 9 | 10 |
| WN 06 LL VA | LL | PN 100 | 6 | 1/8" -27 NPT | 10,0 | 21 | 9,5 | 17 | 9 | 12 |
| WN 08 LL VA | LL | PN 100 | 8 | 1/8" -27 NPT | 10,0 | 21 | 9,5 | 17 | 12 | 14 |
| WN NW 04 HL VA | L | PN 315 | 6 | 1/8" -27 NPT | 10,0 | 27 | 12,0 | 20 | 12 | 14 |
| WN NW 04 HL 1/4 VA | L | PN 315 | 6 | 1/4" -18 NPT | 12,0 | 29 | 14,0 | 26 | 12 | 14 |
| WN NW 04 HL 3/8 VA | L | PN 315 | 6 | 3/8" -18 NPT | 15,3 | 33 | 18,0 | 28 | 14 | 14 |
| WN NW 04 HL 1/2 VA | L | PN 315 | 6 | 1/2" -14 NPT | 17,0 | 38 | 23,0 | 34 | 19 | 14 |
| WN NW 06 HL 1/8 VA | L | PN 315 | 8 | 1/8" -27 NPT | 110,0 | 29 | 14,0 | 26 | 12 | 17 |
| WN NW 06 HL VA | L | PN 315 | 8 | 1/4" -18 NPT | 12,0 | 29 | 14,0 | 26 | 12 | 17 |
| WN NW 06 HL 3/8 VA | L | PN 315 | 8 | 3/8" -18 NPT | 15,2 | 23 | 11,5 | 20 | 12 | 17 |
| WN NW 06 HL 1/2 VA | L | PN 315 | 8 | 1/2" -14 NPT | 17,5 | 30 | 15,0 | 26 | 12 | 17 |
| WN NW 08 HL 1/8 VA | L | PN 315 | 10 | 1/8" -27 NPT | 10,0 | 30 | 15,0 | 27 | 14 | 19 |
| WN NW 08 HL VA | L | PN 315 | 10 | 1/4" -18 NPT | 14,0 | 30 | 15,0 | 27 | 14 | 19 |
| WN NW 08 HL 3/8 VA | L | PN 315 | 10 | 3/8" -18 NPT | 15,2 | 30 | 15,0 | 27 | 14 | 19 |
| WN NW 08 HL 1/2 VA | L | PN 315 | 10 | 1/2" -14 NPT | 20,0 | 37 | 21,0 | 33 | 17 | 19 |
| WN NW 10 HL 1/4 VA | L | PN 315 | 12 | 1/4" -18 NPT | 14,0 | 32 | 17,0 | 28 | 17 | 22 |
| WN NW 10 HL VA | L | PN 315 | 12 | 3/8" -18 NPT | 12,5 | 32 | 17,0 | 28 | 17 | 22 |
| WN NW 10 HL 1/2 VA | L | PN 315 | 12 | 1/2" -14 NPT | 19,0 | 38 | 23,0 | 34 | 19 | 22 |
| WN NW 13 HL 3/8 VA | L | PN 315 | 15 | 3/8" -18 NPT | 13,0 | 36 | 21,0 | 34 | 19 | 27 |
| WN NW 13 HL VA | L | PN 315 | 15 | 1/2" -14 NPT | 18,5 | 36 | 21,0 | 34 | 19 | 27 |
| WN NW 16 HL 3/8 VA | L | PN 315 | 18 | 3/8" -18 NPT | 15,3 | 40 | 23,5 | 36 | 24 | 32 |
| WN NW 16 HL VA | L | PN 315 | 18 | 1/2" -14 NPT | 20,0 | 40 | 23,5 | 36 | 24 | 32 |
| WN NW 16 HL 3/4 VA | L | PN 315 | 18 | 3/4" -14 NPT | 18,5 | 40 | 23,5 | 40 | 24 | 32 |
| WN NW 20 HL 1/2 VA | L | PN 160 | 22 | 1/2" -14 NPT | 20,0 | 44 | 27,5 | 42 | 27 | 36 |
| WN NW 20 HL VA | L | PN 160 | 22 | 3/4" -14 NPT | 18,5 | 44 | 27,5 | 42 | 27 | 36 |
| WN NW 25 HL 3/4 VA | L | PN 160 | 28 | 3/4" -14 NPT | 20,0 | 47 | 30,5 | 48 | 36 | 41 |
| WN NW 25 HL VA | L | PN 160 | 28 | 1" -11,5 NPT | 24,0 | 47 | 30,5 | 48 | 36 | 41 |
| WN NW 32 HL VA | L | PN 160 | 35 | 1.1/4" -11,5 NPT | 25,5 | 56 | 34,5 | 54 | 41 | 50 |
| WN NW 40 HL VA | L | PN 160 | 42 | 1.1/2" -11,5 NPT | 26,0 | 63 | 40,0 | 61 | 50 | 60 |
| WN NW 03 HS VA | S | PN 630 | 6 | 1/4" -18 NPT | 12,0 | 31 | 16,0 | 26 | 12 | 17 |
| WN NW 03 HS 3/8 VA | S | PN 630 | 6 | 3/8" -18 NPT | 15,3 | 32 | 17,5 | 27 | 14 | 17 |
| WN NW 03 HS 1/2 VA | S | PN 630 | 6 | 1/2" -14 NPT | 20,0 | 36 | 21,0 | 34 | 17 | 17 |
| WN NW 04 HS VA | S | PN 630 | 8 | 1/4" -18 NPT | 15,0 | 32 | 17,0 | 27 | 14 | 19 |
| WN NW 04 HS 3/8 VA | S | PN 630 | 8 | 3/8" -18 NPT | 15,3 | 33 | 18,0 | 28 | 14 | 19 |
| WN NW 04 HS 1/2 VA | S | PN 630 | 8 | 1/2" -14 NPT | 20,0 | 38 | 23,0 | 34 | 17 | 19 |
| WN NW 06 HS 1/4 VA | S | PN 630 | 10 | 1/4" -18 NPT | 15,0 | 34 | 17,5 | 28 | 17 | 22 |
| WN NW 06 HS VA | S | PN 630 | 10 | 3/8" -18 NPT | 12,0 | 34 | 17,5 | 28 | 17 | 22 |
| WN NW 06 HS 1/2 VA | S | PN 630 | 10 | 1/2" -14 NPT | 20,0 | 39 | 22,5 | 32 | 17 | 22 |
| WN NW 08 HS 1/4 VA | S | PN 630 | 12 | 1/4" -18 NPT | 15,0 | 38 | 21,5 | 29 | 17 | 24 |
| WN NW 08 HS VA | S | PN 630 | 12 | 3/8" -18 NPT | 12,5 | 38 | 21,5 | 28 | 17 | 24 |



Mimo starannego sprawdzenia nie możemy wykluczyć błędów i nie gwarantujemy prawidłowości podanych informacji.

30.06.2024

HANSA-FLEX AG

www.hansa-flex.com

1

WN VA

Dwuzłączka wkręcana, kąt 90°

HANSA FLEX

Artykuł

| Oznaczenie | Typoszereg | Ciśnienie robocze bar | Średnica zewnętrzna rury Ø (mm) | G | i (mm) | L3 (mm) | L4 (mm) | L5 (mm) | SW (mm) | S3 |
|--------------------|------------|-----------------------|---------------------------------|------------------|--------|---------|---------|---------|---------|----|
| WN NW 08 HS 1/2 VA | S | PN 630 | 12 | 1/2" -14 NPT | 20,0 | 39 | 21,5 | 34 | 17 | 24 |
| WN NW 10 HS 3/8 VA | S | PN 630 | 14 | 3/8" -18 NPT | 15,3 | 40 | 22,0 | 30 | 19 | 27 |
| WN NW 10 HS VA | S | PN 630 | 14 | 1/2" -14 NPT | 18,0 | 40 | 22,0 | 34 | 19 | 27 |
| WN NW 13 HS 3/8 VA | S | PN 400 | 16 | 3/8" -18 NPT | 15,3 | 43 | 24,5 | 32 | 24 | 30 |
| WN NW 13 HS VA | S | PN 400 | 16 | 1/2" -14 NPT | 19,0 | 43 | 24,5 | 36 | 24 | 30 |
| WN NW 13 HS 3/4 VA | S | PN 400 | 16 | 3/4" -14 NPT | 20,0 | 43 | 25,0 | 40 | 24 | 30 |
| WN NW 16 HS 1/2 VA | S | PN 400 | 20 | 1/2" -14 NPT | 20,0 | 48 | 26,5 | 42 | 27 | 36 |
| WN NW 16 HS VA | S | PN 400 | 20 | 3/4" -14 NPT | 20,0 | 48 | 26,6 | 42 | 27 | 36 |
| WN NW 20 HS VA | S | PN 400 | 25 | 1" -11,5 NPT | 24,0 | 54 | 30,0 | 48 | 36 | 46 |
| WN NW 25 HS VA | S | PN 400 | 30 | 1.1/4" -11,5 NPT | 25,5 | 62 | 35,5 | 54 | 41 | 50 |
| WN NW 32 HS VA | S | PN 315 | 38 | 1.1/2" -11,5 NPT | 26,0 | 72 | 41,0 | 61 | 50 | 60 |

PN = ciśnienie znamionowe PB = maks. ciśnienie robocze – typoszereg: LL = bardzo lekki L = lekki S = ciężki – Ø = średnica zewnętrzna rury

Warianty produktu

WN Złączka wkręcana, kąt 90°, stal

WN MG Dwuzłączka wkręcana, kąt 90°, mosiądz

XWN VA Złączka wkręcana, kąt 90°, stal szlachetna