

# K-XV RD 6-KANT

Double nipples, unequal, hexagonal

**HANSA FLEX**

## Właściwości

Ciśnienie pracy	Max. 20 bar
Gwint zewnętrzny	Parallel to DIN EN ISO 228-1
Materiał	Stainless steel 1.4408

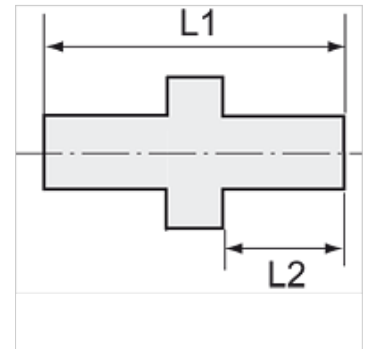
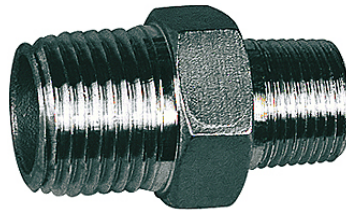

## Wskazówka

The dimensions of the standard screw fittings may change slightly during the life of the catalogue as a result of optimisation processes.

Dalsze informacje na zapytanie.

## Artykuł

Oznaczenie	Gwint 1 zewnętrzny	Gwint 2 zewnętrzny	L1 (mm)	L2 (mm)	RK
K- 07 40 12 27	G 1/4	G 1/8	30,4	11,0	15 mm
K- 07 40 12 28	G 3/8	G 1/8	34,2	12,0	20 mm
K- 07 40 12 29	G 3/8	G 1/4	35,8	12,8	20 mm
K- 07 40 12 30	G 1/2	G 1/4	38,0	13,0	24 mm
K- 07 40 12 31	G 1/2	G 3/8	40,0	15,0	24 mm
K- 07 40 12 32	G 3/4	G 3/8	41,0	16,0	27 mm
K- 07 40 12 33	G 3/4	G 1/2	42,9	16,0	29 mm
K- 07 40 12 34	G 1	G 1/2	46,0	17,0	36 mm
K- 07 40 12 35	G 1	G 3/4	46,0	16,5	36 mm
K- 07 40 12 36	G 1 1/4	G 3/4	50,0	17,5	45 mm
K- 07 40 12 37	G 1 1/4	G 1	51,0	18,5	45 mm
K- 07 40 12 38	G 1 1/2	G 1	52,0	18,5	51 mm
K- 07 40 12 39	G 1 1/2	G 1 1/4	55,0	20,7	51 mm
K- 07 40 12 40	G 2	G 1	58,0	20,0	62 mm
K- 07 40 12 41	G 2	G 1 1/2	60,0	21,5	63 mm