

# K-XVR

Male connectors with male G thread

**HANSA FLEX**

## Właściwości

<b>Ciśnienie robocze</b>	Dependent on operating temperature; Max. 10 bar (at 20 °C); Max. 1 bar (at 60 °C)
<b>korpus dwuzłączki</b>	Polyamide (PA)
<b>pierścień zaciskowy</b>	Polypropylene (PP)
<b>nakrętka</b>	Polypropylene (PP)

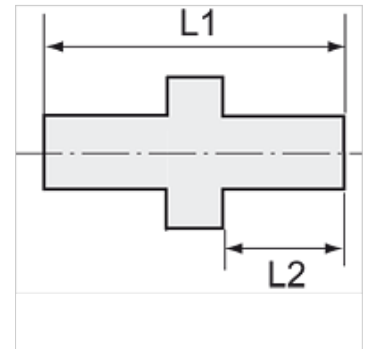
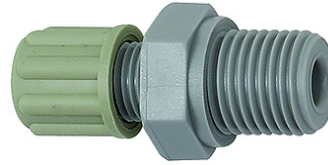

## Wskazówka

Dalsze informacje na zapytanie.

## Opis

Manufactured from high impact-resistant, UV-stabilised engineering plastic, extremely resistant to weathering. Good chemical resistance to benzene, diesel oil, fuel oil and alkalis. <br>Not suitable for use with acids.

## Artykuł

Oznaczenie	Gwint	dla węża	L1 (mm)	L2 (mm)	RK
K- 07 40 32 30	G 1/8	4 mm / 6 mm	31,5	8,0	14 mm
K- 07 40 32 31	G 1/8	6 mm / 8 mm	36,5	8,0	17 mm
K- 07 40 32 32	G 1/8	8 mm / 10 mm	40,5	8,0	19 mm
K- 07 40 32 33	G 1/8	9 mm / 12 mm	44,5	8,0	22 mm
K- 07 40 32 34	G 1/4	4 mm / 6 mm	37,0	12,0	17 mm
K- 07 40 32 35	G 1/4	6 mm / 8 mm	41,0	12,0	17 mm
K- 07 40 32 36	G 1/4	8 mm / 10 mm	45,0	12,0	19 mm
K- 07 40 32 37	G 1/4	9 mm / 12 mm	48,5	12,0	22 mm
K- 07 40 32 38	G 3/8	4 mm / 6 mm	38,5	12,0	22 mm
K- 07 40 32 39	G 3/8	6 mm / 8 mm	42,5	12,0	22 mm
K- 07 40 32 40	G 3/8	8 mm / 10 mm	45,5	12,0	22 mm
K- 07 40 32 41	G 3/8	9 mm / 12 mm	49,5	12,0	22 mm
K- 07 40 32 42	G 1/2	4 mm / 6 mm	43,0	14,0	27 mm
K- 07 40 32 43	G 1/2	6 mm / 8 mm	47,0	14,0	27 mm
K- 07 40 32 44	G 1/2	8 mm / 10 mm	50,0	14,0	27 mm
K- 07 40 32 45	G 1/2	9 mm / 12 mm	54,0	14,0	27 mm