

# K-W90 AG-K ISO 7-1 2

Male elbows, conical male thread acc. to ISO 7-1

**HANSA FLEX**

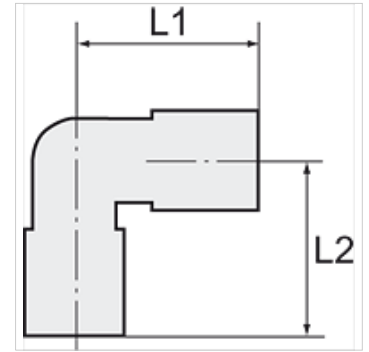
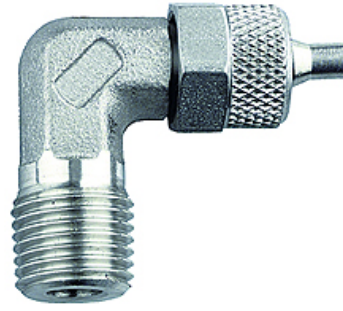

## Wskazówka

Dalsze informacje na zapytanie.

## Artykuł

Oznaczenie	Gwint	dla węża	L1 (mm)	L2 (mm)	RK
K- 07 40 30 27	R 1/8	6 mm / 4 mm	25,0	16,0	9 mm
K- 07 40 30 28	R 1/8	8 mm / 6 mm	27,0	20,0	12 mm
K- 07 40 30 34	R 1/4	10 mm / 8 mm	36,0	28,0	14 mm