

K-W90 DREH AG OR POM

Male elbows, swivel type, parallel male thread with O-ring (M5 - non-swivel type, w/o O-ring)

HANSA FLEX

Właściwości

Ciśnienie pracy	0 - 16 bar (4 - 8 mm); 0 - 10 bar (10 - 28 mm)
Temperatura robocza	-20 °C to +70 °C in air; +1 °C to +70 °C in water
Materiał	Acetalpolimerisat (POM)
Materiał uszczelniający	NBR

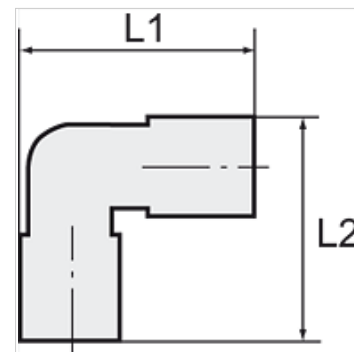

Wskazówka

Dalsze informacje na zapytanie.

Opis

Lightweight, push-in fittings distinguished by high strength, toughness, resistance to abrasion and impact resistance - ideal for a wide range of applications. Plastic and metal tubes are connected together quickly and easily. Suitable for compressed air or liquids, with good resistance to a large number of chemicals.

Artykuł

Oznaczenie	Gwint	do średnicy zewnętrznej węża Ø mm	L1 (mm)	L2 (mm)	RK
K- 07 40 28 85	G 1/8	6 mm	40,0	28,1	15 mm
K- 07 40 28 86	G 1/8	8 mm	45,6	31,1	17 mm
K- 07 40 28 83	G 1/4	6 mm	44,1	28,1	17 mm
K- 07 40 28 84	G 1/4	8 mm	45,5	30,9	17 mm
K- 07 40 28 82	G 1/4	10 mm	50,3	36,2	20 mm
K- 07 40 28 90	G 3/8	8 mm	46,5	30,9	22 mm
K- 07 40 28 87	G 3/8	10 mm	53,3	35,7	22 mm
K- 07 40 28 88	G 3/8	12 mm	60,4	45,0	24 mm
K- 07 40 28 89	G 3/8	15 mm	79,8	51,4	22 mm
K- 07 40 28 78	G 1/2	10 mm	54,8	36,2	27 mm
K- 07 40 28 79	G 1/2	12 mm	63,6	45,5	27 mm
K- 07 40 28 80	G 1/2	15 mm	80,0	50,6	27 mm
K- 07 40 28 81	G 1/2	18 mm	91,5	59,7	27 mm