

K-XV AGM MS NI

Double nipples, parallel male thread, nickel-plated brass

HANSA FLEX

Właściwości

| | |
|---------------------|-------------------|
| Temperatura robocza | Max. 150 °C |
| Ciśnienie | Max. 60 bar |
| Materiał | mosiądz niklowany |

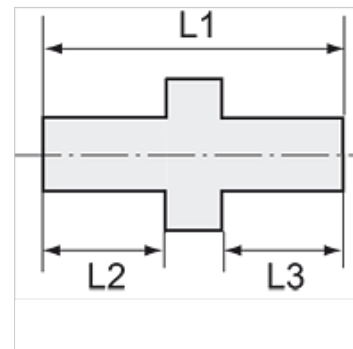
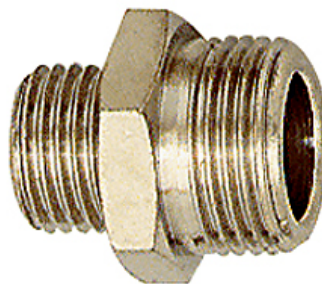

Wskazówka

The dimensions of the standard screw fittings may change slightly during the life of the catalogue as a result of optimisation processes. Dalsze informacje na zapytanie.

Opis

Suitable for air, water, oil, steam, etc.

Dodatkowe informacje

Further types and dimensions on request.

Artykuł

| Oznaczenie | Gwint 1 | Gwint 2 | L1 (mm) | L2 (mm) | L3 (mm) | RK |
|----------------|---------|---------|---------|---------|---------|-------|
| K- 07 40 12 80 | M 5 | M 5 | 11,5 | 4,0 | 4,0 | 8 mm |
| K- 07 40 12 81 | M 5 | G 1/8 | 14,5 | 6,0 | 4,0 | 14 mm |
| K- 07 40 12 82 | G 1/8 | G 1/8 | 17,0 | 6,0 | 6,0 | 14 mm |
| K- 07 40 12 83 | G 1/8 | G 1/4 | 19,0 | 8,0 | 6,0 | 17 mm |
| K- 07 40 12 84 | G 1/8 | G 3/8 | 20,0 | 9,0 | 6,0 | 20 mm |
| K- 07 40 12 85 | G 1/4 | G 1/4 | 21,0 | 8,0 | 8,0 | 17 mm |
| K- 07 40 12 86 | G 1/4 | G 3/8 | 22,0 | 9,0 | 8,0 | 20 mm |
| K- 07 40 12 87 | G 1/4 | G 1/2 | 24,0 | 10,0 | 8,0 | 25 mm |
| K- 07 40 12 88 | G 3/8 | G 3/8 | 24,0 | 9,0 | 9,0 | 20 mm |
| K- 07 40 12 89 | G 3/8 | G 1/2 | 25,5 | 10,0 | 9,0 | 25 mm |
| K- 07 40 45 02 | G 3/8 | G 3/4 | 27,0 | 12,0 | 9,0 | 27 mm |
| K- 07 40 12 90 | G 1/2 | G 1/2 | 26,5 | 10,0 | 10,0 | 25 mm |
| K- 07 40 12 91 | G 1/2 | G 3/4 | 27,5 | 11,0 | 10,0 | 30 mm |
| K- 07 40 45 03 | G 1/2 | G 1 | 32,5 | 15,0 | 10,5 | 34 mm |
| K- 07 40 12 93 | G 3/4 | G 3/4 | 28,0 | 11,0 | 11,0 | 30 mm |
| K- 07 40 12 92 | G 3/4 | G 1 | 30,0 | 11,0 | 12,0 | 36 mm |
| K- 07 40 12 94 | G 1 | G 1 | 31,0 | 12,0 | 12,0 | 36 mm |
| K- 07 40 45 04 | G 1 | G 1 1/4 | 38,0 | 16,0 | 15,0 | 43 mm |
| K- 07 40 45 05 | G 1 | G 1 1/2 | 38,5 | 16,0 | 15,0 | 50 mm |
| K- 07 40 45 06 | G 1 | G 2 | 42,0 | 18,0 | 15,0 | 60 mm |
| K- 07 40 45 07 | G 1 1/4 | G 1 1/4 | 39,0 | 16,0 | 16,0 | 42 mm |
| K- 07 40 45 08 | G 1 1/4 | G 1 1/2 | 40,0 | 16,0 | 16,0 | 50 mm |
| K- 07 40 45 09 | G 1 1/4 | G 2 | 43,0 | 18,0 | 16,0 | 60 mm |
| K- 07 40 45 10 | G 1 1/2 | G 1 1/2 | 39,5 | 16,0 | 16,0 | 50 mm |
| K- 07 40 45 11 | G 1 1/2 | G 2 | 44,5 | 18,0 | 17,5 | 60 mm |
| K- 07 40 45 12 | G 2 | G 2 | 44,0 | 17,5 | 17,5 | 60 mm |
| K- 07 40 45 13 | G 2 | G 2 1/2 | 54,0 | 24,0 | 19,0 | 77 mm |
| K- 07 40 45 14 | G 2 | G 3 | 50,0 | 20,0 | 20,0 | 89 mm |
| K- 07 40 45 15 | G 2 1/2 | G 2 1/2 | 59,0 | 24,0 | 24,0 | 77 mm |
| K- 07 40 45 16 | G 2 1/2 | G 3 | 52,5 | 20,0 | 22,5 | 89 mm |
| K- 07 40 45 17 | G 3 | G 3 | 60,0 | 24,5 | 24,5 | 89 mm |