

K-VLST K AG IG MS NI

Extensions, short, parallel - nickel-plated brass

HANSA FLEX

Właściwości

| | |
|---------------------|---------------------|
| Temperatura robocza | Max. 150 °C |
| Ciśnienie | Max. 60 bar |
| Materiał | mosiądz nikielowany |

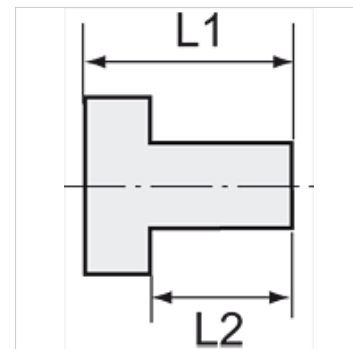
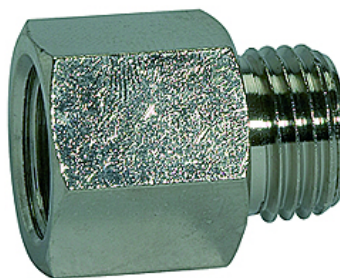

Wskazówka

The dimensions of the standard screw fittings may change slightly during the life of the catalogue as a result of optimisation processes.
Dalsze informacje na zapytanie.

Opis

Suitable for air, water, oil, steam, etc.

Dodatkowe informacje

Further types and dimensions on request.

Artykuł

| Oznaczenie | Gwint zewnętrzny | Gwint wewnętrzny | L1 (mm) | L2 (mm) | RK |
|----------------|------------------|------------------|------------|------------|-------|
| K- 07 40 39 01 | M 5 | G 1/8 | 17,0 | 4,0 | 12 mm |
| K- 07 40 39 02 | G 1/8 | G 1/8 | 18,5 | 6,0 | 14 mm |
| K- 07 40 39 03 | G 1/8 | G 1/4 | 21,5 | 6,0 | 17 mm |
| K- 07 40 39 04 | G 1/4 | G 1/4 | 22,5 | 8,0 | 17 mm |
| K- 07 40 39 05 | G 1/4 | G 3/8 | 26,0 | 8,0 | 22 mm |
| K- 07 40 39 06 | G 3/8 | G 3/8 | 26,5 | 9,0 | 22 mm |
| K- 07 40 39 07 | G 3/8 | G 1/2 | 29,5 | 9,0 | 24 mm |
| K- 07 40 39 08 | G 1/2 | G 1/2 | 29,5 | 10,0 | 25 mm |