

K-DRG DRVS VARIOBLOC

Pressure regulators with pressure supply at both ends

HANSA FLEX

Właściwości

| | |
|---------------------------|--|
| Ciśnienie wejściowe | Max. 25 bar |
| Temperatura czynnika | max. 50 °C |
| temperatura otoczenia | Max. 50 °C |
| Materiał uszczelniający | NBR |
| kołpak sprężynujący | POM-brass |
| Obudowa | Die-cast zinc |
| pomiar wartości przepływu | At P1 = 10 bar, P2 = 6 bar and pressure drop $\Delta p = 1$ bar |

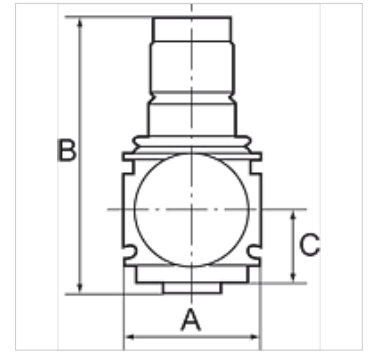

Wskazówka

Dalsze informacje na zapytanie.

Opis

Diaphragm pressure regulators with self-relieving design for mounting side by side. The pressure setting can be locked by pushing the knob down.
By assembling two or more controllers together, it is possible to supply several working air circuits with different output pressures via a single supply line.

Wskazówki do zamówienia

Pressure regulators are also available in lockable version. Please ask for more information.

Artykuł

| Oznaczenie | Gwint | Zakres regulacji | Przepływ (L/min) | A (mm) | B | C (mm) |
|----------------|-------|------------------|------------------|--------|---------|--------|
| K- 07 25 04 33 | G 1/4 | 0.5 - 6 bar | 1800 | 48,0 | 98,0 mm | 26,0 |
| K- 07 25 04 34 | G 1/4 | 0.5 - 10 bar | 1800 | 48,0 | 98,0 mm | 26,0 |
| K- 07 25 04 35 | G 1/4 | 0.5 - 16 bar | 1800 | 48,0 | 98,0 mm | 26,0 |
| K- 07 25 04 36 | G 3/8 | 0.5 - 6 bar | 1800 | 48,0 | 98,0 mm | 26,0 |
| K- 07 25 04 37 | G 3/8 | 0.5 - 10 bar | 1800 | 48,0 | 98,0 mm | 26,0 |
| K- 07 25 04 38 | G 3/8 | 0.5 - 16 bar | 1800 | 48,0 | 98,0 mm | 26,0 |

Części zamienne

K-VERSCHLEI-SATZ VARIOBLOC Set of wearing parts