

K-XV ARG-K MS NI

Double nipples, conical male thread - nickel-plated brass

HANSA FLEX

Właściwości

Temperatura robocza	Max. 150 °C
Ciśnienie	Max. 60 bar
Materiał	mosiądz niklowany

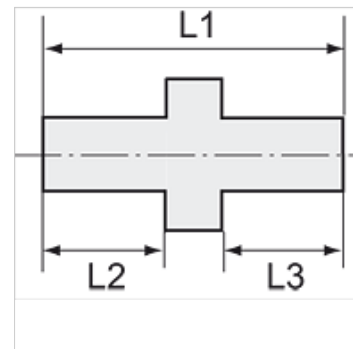
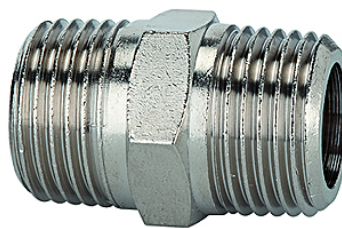

Wskazówka

The dimensions of the standard screw fittings may change slightly during the life of the catalogue as a result of optimisation processes.
Dalsze informacje na zapytanie.

Opis

Suitable for air, water, oil, steam, etc.

Dodatkowe informacje

Further types and dimensions on request.

Artykuł

Oznaczenie	Gwint 1	Gwint 2	L1 (mm)	L2 (mm)	L3 (mm)	RK
K- 07 40 12 60	R 1/8	R 1/8	21,0	8,0	8,0	12 mm
K- 07 40 12 61	R 1/8	R 1/4	24,0	11,0	8,0	14 mm
K- 07 40 12 62	R 1/8	R 3/8	25,0	11,5	8,0	17 mm
K- 07 40 12 63	R 1/4	R 1/4	27,0	11,0	11,0	14 mm
K- 07 40 12 64	R 1/4	R 3/8	28,0	11,5	11,0	17 mm
K- 07 40 12 65	R 1/4	R 1/2	32,0	14,0	11,0	22 mm
K- 07 40 12 66	R 3/8	R 3/8	29,0	11,5	11,5	17 mm
K- 07 40 12 67	R 3/8	R 1/2	32,5	14,0	11,5	22 mm
K- 07 40 12 68	R 1/2	R 1/2	35,0	14,0	14,0	22 mm
K- 07 40 12 69	R 1/2	R 3/4	37,0	16,5	14,0	27 mm
K- 07 40 12 71	R 3/4	R 3/4	40,0	16,5	16,5	27 mm
K- 07 40 12 70	R 3/4	R 1	42,5	19,0	16,5	34 mm
K- 07 40 12 72	R 1	R 1	45,5	19,0	19,0	34 mm