

# K-STECKVERSCHR IG SK

Male connectors, parallel female thread with outer hex

**HANSA FLEX**

## Właściwości

Ciśnienie pracy Max. 16 bar

Temperatura robocza -20 °C to +80 °C

Materiał mosiądz niklowany

pierścień dociskowy Hostaform

pierścień zaciskowy Stainless steel

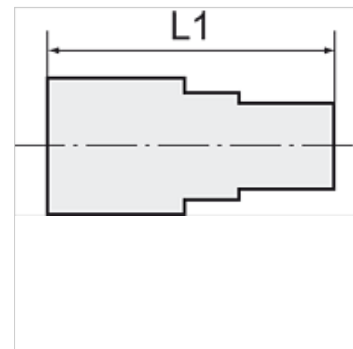
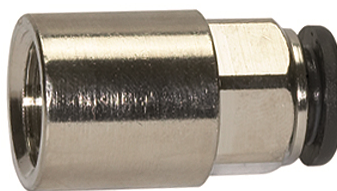

## Wskazówka

Dalsze informacje na zapytanie.

## Opis

The advanced version of our highly successful push-in fittings series manufactured in nickel-plated brass. Advantages of this new, optimised series: Much easier connection and disconnection of the hose, even with repeated mounting, can also be used for non-calibrated hoses, suitable for vacuum operation.

## Artykuł

Oznaczenie	Gwint	do średnicy zewnętrznej węża Ø mm	L1 (mm)	RK
K- 07 40 25 06	M 5	3 mm	15,7	7 mm
K- 07 40 25 12	G 1/8	4 mm	26,2	10 mm
K- 07 40 25 13	G 1/8	5 mm	27,5	12 mm
K- 07 40 25 14	G 1/8	6 mm	27,1	12 mm
K- 07 40 25 15	G 1/8	8 mm	28,1	13 mm
K- 07 40 25 09	G 1/4	4 mm	28,6	10 mm
K- 07 40 47 15	G 1/4	5 mm	29,5	12 mm
K- 07 40 25 10	G 1/4	6 mm	29,3	12 mm
K- 07 40 25 11	G 1/4	8 mm	30,0	14 mm
K- 07 40 25 08	G 1/4	10 mm	31,8	16 mm
K- 07 40 25 16	G 3/8	10 mm	36,8	16 mm
K- 07 40 25 17	G 3/8	12 mm	37,0	19 mm
K- 07 40 25 07	G 1/2	12 mm	40,5	19 mm