

# K-SCHOTT-STECKVERB 3

Female bulkhead connectors

**HANSA FLEX**

## Właściwości

<b>Ciśnienie pracy</b>	Max. 15 bar, coarse vacuum
<b>Zakres stosowania</b>	Air, vacuum
<b>zalecane węże</b>	PU or PA (nylon)
<b>Czynniki robocze</b>	Compressed air and all gases or liquids that are compatible with the materials
<b>Zakres temperatury</b>	-20 °C to +80 °C
<b>Materiał</b>	Plastic, Nickel plated brass
<b>pierścień dociskowy</b>	Plastic

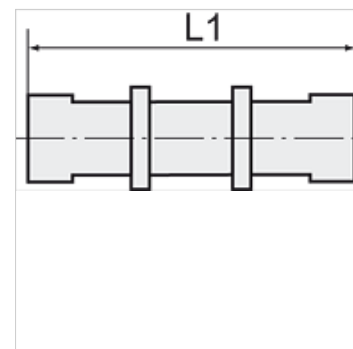
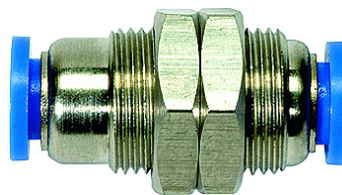

## Wskazówka

Dalsze informacje na zapytanie.

## Opis

Push-in fittings series manufactured in plastic and nickel-plated brass. All parts are suitable for use with hoses, tubes or pipes made of plastic and copper.

## Artykuł

Oznaczenie	do średnicy zewnętrznej węża Ø mm	Gwint tablica rozdzielcza	L1 (mm)	RK
K- 07 40 04 31	4 mm	M 12 x 1	31,1	14 mm
K- 07 40 04 32	6 mm	M 14 x 1	33,4	17 mm
K- 07 40 04 33	8 mm	M 16 x 1	37,7	19 mm
K- 07 40 04 34	10 mm	M 20 x 1	41,8	24 mm
K- 07 40 04 35	12 mm	M 22 x 1	46,7	27 mm
K- 07 40 04 36	16 mm	M 27 x 1	51,2	32 mm