

K-Y-STECK VERSCH DREH AG OR

Male branch Y-fittings, swivel type, parallel male thread with O-ring

HANSA FLEX

Właściwości

| | |
|-----------------------------|--|
| Ciśnienie pracy | Max. 15 bar, coarse vacuum |
| Zakres stosowania | Air, vacuum |
| zalecane węże | PU or PA (nylon) |
| Czynniki robocze | Compressed air and all gases or liquids that are compatible with the materials |
| Zakres temperatury | -20 °C to +80 °C |
| Powierzchnia uszczelniająca | Parallel version: O-ring in housing |
| Materiał | Plastic, Nickel plated brass |
| pierścień dociskowy | Plastic |

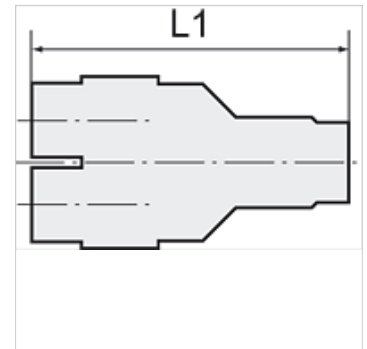

Wskazówka

Dalsze informacje na zapytanie.

Opis

Push-in fittings series manufactured in plastic and nickel-plated brass. All parts are suitable for use with hoses, tubes or pipes made of plastic and copper.

Artykuł

| Oznaczenie | Gwint | do średnicy zewnętrznej węża Ø mm | L1 (mm) | RK |
|----------------|-------|-----------------------------------|---------|-------|
| K- 07 40 02 97 | M 5 | 4 mm | 39,5 | 10 mm |
| K- 07 40 02 98 | M 5 | 6 mm | 40,0 | 12 mm |
| K- 07 40 03 11 | G 1/8 | 4 mm | 42,5 | 12 mm |
| K- 07 40 03 12 | G 1/8 | 6 mm | 43,5 | 14 mm |
| K- 07 40 03 13 | G 1/8 | 8 mm | 46,3 | 14 mm |
| K- 07 40 03 09 | G 1/8 | 10 mm | 55,5 | 17 mm |
| K- 07 40 03 10 | G 1/8 | 12 mm | 58,4 | 21 mm |
| K- 07 40 03 06 | G 1/4 | 4 mm | 44,0 | 12 mm |
| K- 07 40 03 07 | G 1/4 | 6 mm | 45,0 | 14 mm |
| K- 07 40 03 08 | G 1/4 | 8 mm | 47,8 | 17 mm |
| K- 07 40 03 04 | G 1/4 | 10 mm | 56,5 | 17 mm |
| K- 07 40 03 05 | G 1/4 | 12 mm | 59,4 | 21 mm |
| K- 07 40 03 17 | G 3/8 | 6 mm | 46,5 | 14 mm |
| K- 07 40 03 18 | G 3/8 | 8 mm | 49,3 | 17 mm |
| K- 07 40 03 14 | G 3/8 | 10 mm | 58,0 | 20 mm |
| K- 07 40 03 15 | G 3/8 | 12 mm | 60,4 | 21 mm |
| K- 07 40 03 16 | G 3/8 | 16 mm | 69,0 | 24 mm |
| K- 07 40 03 02 | G 1/2 | 6 mm | 49,0 | 14 mm |
| K- 07 40 03 03 | G 1/2 | 8 mm | 52,8 | 17 mm |
| K- 07 40 02 99 | G 1/2 | 10 mm | 61,5 | 19 mm |
| K- 07 40 03 00 | G 1/2 | 12 mm | 63,9 | 24 mm |
| K- 07 40 03 01 | G 1/2 | 16 mm | 72,5 | 24 mm |