

K-SCHOTT-STECKVERB 2

Female bulkhead connectors

HANSA FLEX

Właściwości

| | |
|---------------------|---------------------|
| Ciśnienie pracy | Max. 16 bar |
| Temperatura robocza | -20 °C to +150 °C |
| Materiał | mosiądz nikielowany |
| pierścień dociskowy | Nickel-plated brass |
| pierścień zaciskowy | Stainless steel |

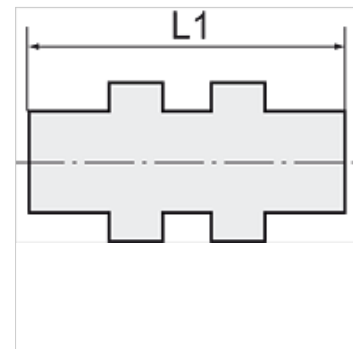
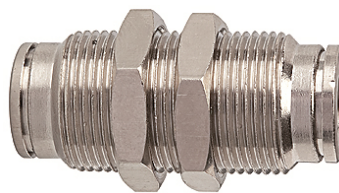

Wskazówka

Dalsze informacje na zapytanie.

Opis

Push-in fittings, manufactured entirely in nickel-plated brass. All parts with a parallel thread are supplied with an FPM O-ring. All parts with conical threads are coated with preCOTE 5 dispersion, all fittings in this series can thus also be used at high temperatures (medium compressed air).

Artykuł

| Oznaczenie | Gwint | do średnicy zewnętrznej węża Ø mm | L1 (mm) | RK |
|----------------|----------|-----------------------------------|---------|-------|
| K- 07 40 27 61 | M 10 x 1 | 4 mm | 31,5 | 13 mm |
| K- 07 40 27 62 | M 14 x 1 | 6 mm | 33,5 | 17 mm |
| K- 07 40 27 63 | M 16 x 1 | 8 mm | 37,0 | 18 mm |
| K- 07 40 27 64 | M 17 x 1 | 10 mm | 39,5 | 20 mm |
| K- 07 40 47 83 | M 20 x 1 | 12 mm | 42,0 | 24 mm |
| K- 07 40 47 84 | M 22 x 1 | 14 mm | 46,0 | 25 mm |