

Características

Conexão 1	Rosca externa métrica cilíndrica
Tipo de vedação 1	Forma F
Conexão 2	Rosca externa métrica cilíndrica
Tipo de vedação 2	Cone interno 24°
Tipo	União orientável sem estrangulamento
Modelo	Ângulo de 90°
Norma	DIN 2353 ISO 8434-1
Escopo de fornecimento	Conexão com porca e anilha
Material	Aço
Proteção de superfície	com revestimento galvanizado

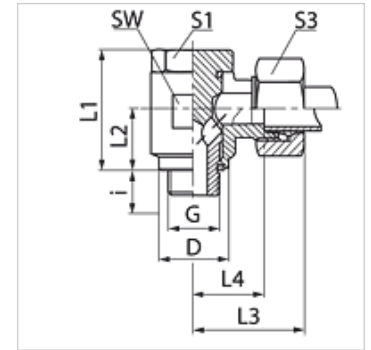

Nota

As instruções relativas à montagem e instalação, às cargas de pressão e às temperaturas operacionais admissíveis constam nas Informações Técnicas para Conexões para tubo.

Artigo

Descrição	Série	Pressão operacional bar	Ø externo do tubo (mm)	G	D (mm)	i (mm)	L1 (mm)	L2 (mm)	L3 (mm)	L4 (mm)	SW (mm)	S1	S3	OR
SDOM 06 LL	LL	PN 100	6	M 10 x 1	14,7	8,0	23,5	10,5	28,0	13,5	17	17	12	7,65 x 1,78
SDOM 08 LL	LL	PN 100	8	M 10 x 1	14,7	8,0	23,5	10,5	28,0	13,5	17	17	14	7,65 x 1,78
SDOM NW 04 HL	L	PN 315	6	M 10 x 1	14,0	8,0	24,0	10,5	27,0	12,0	17	17	14	7,65 x 1,78
SDOM NW 06 HL	L	PN 315	8	M 12 x 1,5	17,0	12,0	30,0	14,0	29,0	14,5	22	19	17	11,10 x 1,78
SDOM NW 08 HL	L	PN 315	10	M 14 x 1,5	19,0	12,0	30,0	14,0	30,0	15,5	22	19	19	11,10 x 1,78
SDOM NW 10 HL	L	PN 315	12	M 16 x 1,5	21,0	12,0	36,0	16,5	33,0	18,0	27	24	22	14,00 x 1,78
SDOM NW 10 HL 18	L	PN 315	12	M 18 x 1,5	23,5	12,0	35,0	16,5	33,0	18,0	27	24	22	18,77 x 1,78
SDOM NW 13 HL	L	PN 315	15	M 18 x 1,5	23,0	12,0	39,5	18,5	37,0	21,5	30	27	27	18,77 x 1,78
SDOM NW 16 HL	L	PN 315	18	M 22 x 1,5	27,0	14,0	45,0	21,5	37,0	21,0	32	30	32	18,77 x 1,78
SDOM NW 20 HL	L	PN 160	22	M 26 x 1,5	31,0	16,0	53,0	24,0	44,0	27,5	41	36	36	23,81 x 2,62
SDOM NW 25 HL	L	PN 160	28	M 33 x 2	39,0	18,0	66,0	30,5	49,0	32,0	50	46	41	29,82 x 2,62
SDOM NW 32 HL	L	PN 160	35	M 42 x 2	49,0	20,0	76,0	35,5	58,0	36,0	60	55	50	37,77 x 2,62
SDOM NW 40 HL	L	PN 160	42	M 48 x 2	55,0	22,0	87,0	40,5	63,0	40,5	70	60	60	41,28 x 3,53
SDOM NW 03 HS	S	PN 400	6	M 12 x 1,5	17,0	12,0	30,0	14,0	31,0	16,5	22	19	17	11,10 x 1,78
SDOM NW 04 HS	S	PN 400	8	M 14 x 1,5	19,0	12,0	30,0	14,0	31,0	16,5	22	19	19	11,10 x 1,78
SDOM NW 06 HS	S	PN 400	10	M 16 x 1,5	21,0	12,0	35,0	16,5	35,0	18,5	27	24	22	14,00 x 1,78
SDOM NW 08 HS	S	PN 400	12	M 18 x 1,5	23,0	12,0	39,5	18,5	36,0	20,0	30	27	24	18,77 x 1,78
SDOM NW 10 HS	S	PN 400	14	M 20 x 1,5	25,0	14,0	43,5	20,0	40,0	22,5	32	30	27	18,77 x 1,78
SDOM NW 13 HS	S	PN 315	16	M 22 x 1,5	27,0	14,0	45,0	21,5	40,0	22,0	32	30	30	18,77 x 1,78
SDOM NW 16 HS	S	PN 315	20	M 27 x 2	32,0	16,0	53,0	24,0	48,0	26,5	41	36	36	23,81 x 2,62
SDOM NW 20 HS	S	PN 250	25	M 33 x 2	39,0	18,0	66,0	30,5	56,0	31,5	50	46	46	29,38 x 2,62
SDOM NW 25 HS	S	PN 160	30	M 42 x 2	49,0	20,0	76,0	35,5	64,0	37,0	60	55	50	37,77 x 2,62
SDOM NW 32 HS	S	PN 160	38	M 48 x 2	55,0	22,0	87,0	40,5	72,0	41,5	70	60	60	41,28 x 3,53

PN = Pressão nominal PB = Pressão operacional máx. - Série: LL = muito leve L = leve S = pesada - Ø = diâmetro externo do tubo

Variantes do produto

SDOM VA	União orientável, sem estrangulamento, ângulo 90°, Aço inoxidável
XSDOM	União orientável, sem estrangulamento, ângulo 90°, Aço