

Características

| | |
|-------------------------------|--------------------------------------|
| Conexão 1 | Rosca externa métrica cilíndrica |
| Tipo de vedação 1 | Forma E |
| Conexão 2 | Rosca externa métrica cilíndrica |
| Tipo de vedação 2 | Cone interno 24° |
| Tipo | União orientável sem estrangulamento |
| Modelo | Ângulo de 90° |
| Norma | DIN 2353 ISO 8434-1 |
| Escopo de fornecimento | Conexão (sem porca e anilha) |
| Material | Aço |
| Proteção de superfície | com revestimento galvanizado |

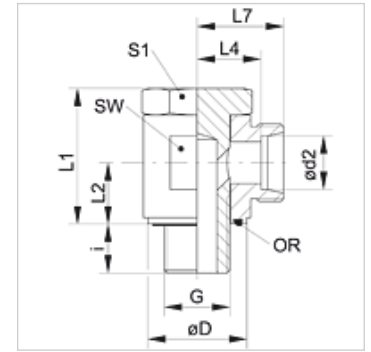

Nota

As instruções relativas à montagem e instalação, às cargas de pressão e às temperaturas operacionais admissíveis constam nas Informações Técnicas para Conexões para tubo.

Artigo

| Descrição | Série | Pressão operacional bar | Ø d2 (mm) | G | Ø D (mm) | i (mm) | L1 (mm) | L2 (mm) | L4 (mm) | L7 (mm) | SW (mm) | S1 | OR |
|-------------------|-------|-------------------------|-----------|------------|----------|--------|---------|---------|---------|---------|---------|----|--------------|
| XSDOM 06 LL | LL | PN 100 | 6 | M 10 x 1 | 14,5 | 8,0 | 23,5 | 10,5 | 13,5 | 19,0 | 17 | 17 | 7,65 x 1,78 |
| XSDOM 08 LL | LL | PN 100 | 8 | M 10 x 1 | 14,5 | 8,0 | 23,5 | 10,5 | 13,5 | 19,0 | 17 | 17 | 7,65 x 1,78 |
| XSDOM NW 04 HL | L | PN 315 | 6 | M 10 x 1 | 14,0 | 8,0 | 24,0 | 10,5 | 12,0 | 19,0 | 17 | 17 | 7,65 x 1,78 |
| XSDOM NW 06 HL | L | PN 315 | 8 | M 12 x 1,5 | 17,0 | 12,0 | 30,0 | 14,0 | 14,5 | 21,5 | 22 | 19 | 11,10 x 1,78 |
| XSDOM NW 08 HL | L | PN 315 | 10 | M 14 x 1,5 | 19,0 | 12,0 | 30,0 | 14,0 | 15,5 | 22,5 | 22 | 19 | 11,10 x 1,78 |
| XSDOM NW 10 HL | L | PN 315 | 12 | M 16 x 1,5 | 21,0 | 12,0 | 36,0 | 16,5 | 18,0 | 25,0 | 27 | 24 | 14,00 x 1,78 |
| XSDOM NW 10 HL 18 | L | PN 315 | 12 | M 18 x 1,5 | 23,5 | 12,0 | 35,0 | 16,5 | 18,0 | 25,0 | 27 | 24 | 18,77 x 1,78 |
| XSDOM NW 13 HL | L | PN 315 | 15 | M 18 x 1,5 | 23,0 | 12,0 | 39,5 | 18,5 | 21,5 | 28,5 | 30 | 27 | 18,77 x 1,78 |
| XSDOM NW 16 HL | L | PN 315 | 18 | M 22 x 1,5 | 27,0 | 14,0 | 45,0 | 21,5 | 21,0 | 28,5 | 32 | 30 | 18,77 x 1,78 |
| XSDOM NW 20 HL | L | PN 160 | 22 | M 26 x 1,5 | 31,0 | 16,0 | 53,0 | 24,0 | 27,5 | 35,0 | 41 | 36 | 23,81 x 2,62 |
| XSDOM NW 25 HL | L | PN 160 | 28 | M 33 x 2 | 39,0 | 18,0 | 66,0 | 30,5 | 32,0 | 39,5 | 50 | 46 | 29,82 x 2,62 |
| XSDOM NW 32 HL | L | PN 160 | 35 | M 42 x 2 | 49,0 | 20,0 | 76,0 | 35,5 | 36,0 | 46,5 | 60 | 55 | 37,77 x 2,62 |
| XSDOM NW 40 HL | L | PN 160 | 42 | M 48 x 2 | 55,0 | 22,0 | 87,0 | 40,5 | 40,5 | 51,5 | 70 | 60 | 41,28 x 3,53 |
| XSDOM NW 03 HS | S | PN 400 | 6 | M 12 x 1,5 | 17,5 | 12,0 | 30,0 | 14,0 | 16,5 | 23,5 | 22 | 19 | 11,10 x 1,78 |
| XSDOM NW 04 HS | S | PN 400 | 8 | M 14 x 1,5 | 19,0 | 12,0 | 30,0 | 14,0 | 16,5 | 23,5 | 22 | 19 | 11,10 x 1,78 |
| XSDOM NW 06 HS | S | PN 400 | 10 | M 16 x 1,5 | 21,0 | 12,0 | 35,0 | 16,5 | 18,5 | 26,0 | 27 | 24 | 14,00 x 1,78 |
| XSDOM NW 08 HS | S | PN 400 | 12 | M 18 x 1,5 | 23,0 | 12,0 | 39,5 | 18,5 | 20,0 | 27,5 | 30 | 27 | 18,77 x 1,78 |
| XSDOM NW 10 HS | S | PN 400 | 14 | M 20 x 1,5 | 25,0 | 14,0 | 43,5 | 20,0 | 22,5 | 30,5 | 32 | 30 | 18,77 x 1,78 |
| XSDOM NW 13 HS | S | PN 315 | 16 | M 22 x 1,5 | 27,0 | 14,0 | 45,0 | 21,5 | 22,0 | 30,5 | 32 | 30 | 18,77 x 1,78 |
| XSDOM NW 16 HS | S | PN 315 | 20 | M 27 x 2 | 32,0 | 16,0 | 53,0 | 24,0 | 26,5 | 37,0 | 41 | 36 | 23,81 x 2,62 |
| XSDOM NW 20 HS | S | PN 250 | 25 | M 33 x 2 | 39,0 | 18,0 | 66,0 | 30,5 | 31,5 | 43,5 | 50 | 46 | 29,82 x 2,62 |
| XSDOM NW 25 HS | S | PN 160 | 30 | M 42 x 2 | 49,0 | 20,0 | 76,0 | 35,5 | 37,0 | 50,5 | 60 | 55 | 37,77 x 2,62 |
| XSDOM NW 32 HS | S | PN 160 | 38 | M 48 x 2 | 55,0 | 22,0 | 87,0 | 40,5 | 41,5 | 57,5 | 70 | 60 | 41,28 x 3,53 |

PN = Pressão nominal PB = Pressão operacional máx. - Série: LL = muito leve L = leve S = pesada - Ø = diâmetro externo do tubo

Variantes do produto

| | |
|-----------------|---|
| XSDOM VA | União orientável, sem estrangulamento, ângulo 90°, Aço inoxidável |
| SDOM | União orientável, sem estrangulamento, ângulo 90°, Aço |