

K-DRV

Unidirectional flow control valves

Características

Pressão operacional	máx. 10 bar
Temperatura operacional	max. +70 °C
Material de vedação	NBR
Carcaça	Alu eloxed
Peças interiores	Brass

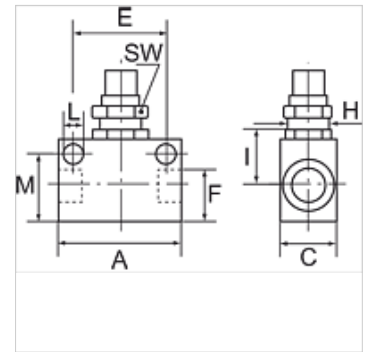
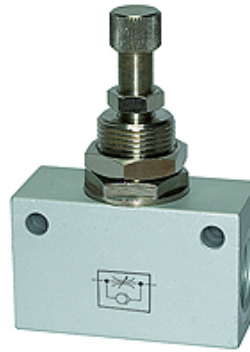

Nota

Outras indicações a pedido.

Descrição

These valves are restricted in the flow direction and have free passage in the opposite direction.

Artigo

Descrição	Rosca	A (mm)	C (mm)	E (mm)	Dimensão H	I (mm)	L (mm)	M (mm)	SW (mm)
K- 07 30 12 36	M 5	25,0	12,0	18,0	M 9 x 0.75 mm	10,0	3,2	12,2	11
K- 07 30 12 37	G 1/8	34,0	16,0	24,0	M 12 x 0.75 mm	15,0	4,5	16,4	15
K- 07 30 12 38	G 1/4	50,0	25,0	35,0	M 18 x 1.5 mm	24,0	6,5	23,8	22
K- 07 30 12 39	G 3/8	58,0	25,0	40,0	M 18 x 1.5 mm	24,0	6,5	25,3	22
K- 07 30 12 40	G 1/2	65,0	30,0	50,0	M 22 x 1.5 mm	29,0	6,5	33,0	26