

# K-XG LOESBAR IG AG 2

Detachable double nipples, female-male, taper seat

**HANSA FLEX**

## Características

|                     |                              |
|---------------------|------------------------------|
| Pressão de trabalho | Max. 10 bar                  |
| Rosca externa       | Parallel to DIN EN ISO 228-1 |
| Rosca interna       | Parallel to DIN EN ISO 228-1 |
| Material            | Aço inoxidável 1.4408        |

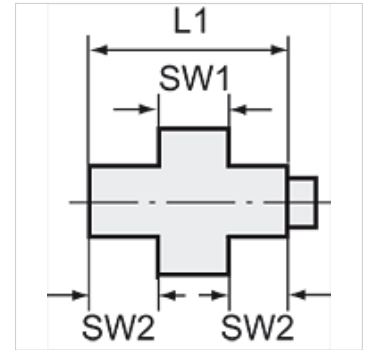
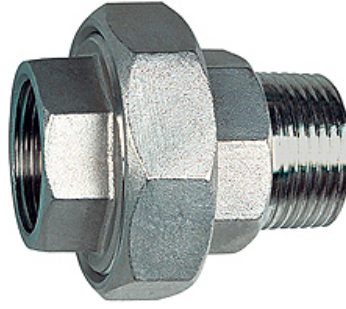

## Nota

The dimensions of the standard screw fittings may change slightly during the life of the catalogue as a result of optimisation processes.  
Outras indicações a pedido.

## Artigo

| Descrição      | Rosca   | L1<br>(mm) | SW1<br>(mm) | SW2<br>(mm) |
|----------------|---------|------------|-------------|-------------|
| K- 07 40 12 51 | G 1/8   | 42,3       | 29          | 18          |
| K- 07 40 12 52 | G 1/4   | 43,0       | 29          | 18          |
| K- 07 40 12 53 | G 3/8   | 46,0       | 34          | 22          |
| K- 07 40 12 54 | G 1/2   | 56,0       | 39          | 26          |
| K- 07 40 12 55 | G 3/4   | 59,7       | 47          | 32          |
| K- 07 40 12 56 | G 1     | 67,0       | 58          | 40          |
| K- 07 40 12 57 | G 1 1/4 | 76,0       | 67          | 49          |
| K- 07 40 12 58 | G 1 1/2 | 81,0       | 76          | 56          |
| K- 07 40 12 59 | G 2     | 89,0       | 90          | 68          |