

K-HOCHLEIST SCHALLDAEMP

High-performance silencers

HANSA FLEX

Características

Temperatura operacional	-10 °C to +90 °C
Posição de montagem	Qualquer
Pressão de retorno (entrada)	Max. 6 bar
Material	Carcaça de chapa de aço revestida a pó, chapa perfurada zincada, feltro de poliéster

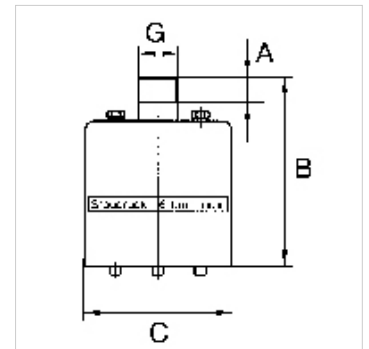

Nota

Outras indicações a pedido.

Descrição

Multi-chamber silencers with a high blow-off rate, short exhaust time and excellent silencing effect.

Artigo

Descrição	Fluxo 6bar	Rosca	A (mm)	B (mm)	C (mm)
K- 07 40 14 31	13350 l/min	G 1/2	14,0	103,0	80,0
K- 07 40 14 32	16700 l/min	G 3/4	16,0	106,0	80,0
K- 07 40 14 33	23350 l/min	G 1	18,0	130,0	110,0
K- 07 40 14 34	31700 l/min	G 1 1/4	20,0	136,0	110,0
K- 07 40 14 35	53400 l/min	G 1 1/2	24,0	168,0	150,0
K- 07 40 14 36	56700 l/min	G 2	24,0	168,0	150,0