

K-VLST K AG IG MS NI

Extensions, short, parallel - nickel-plated brass

HANSA FLEX

Características

Temperatura operacional Max. 150 °C

Pressão Max. 60 bar

Material Latão niquelado

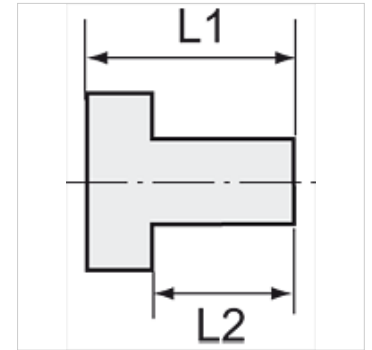
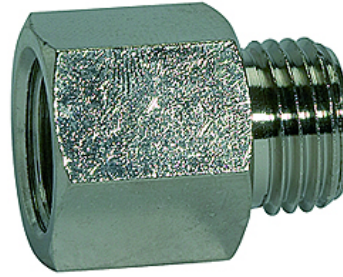

Nota

The dimensions of the standard screw fittings may change slightly during the life of the catalogue as a result of optimisation processes. Outras indicações a pedido.

Descrição

Suitable for air, water, oil, steam, etc.

Informações adicionais

Further types and dimensions on request.

Artigo

Descrição	Rosca externa	Rosca interna	L1 (mm)	L2 (mm)	SW
K- 07 40 39 01	M 5	G 1/8	17,0	4,0	12 mm
K- 07 40 39 02	G 1/8	G 1/8	18,5	6,0	14 mm
K- 07 40 39 03	G 1/8	G 1/4	21,5	6,0	17 mm
K- 07 40 39 04	G 1/4	G 1/4	22,5	8,0	17 mm
K- 07 40 39 05	G 1/4	G 3/8	26,0	8,0	22 mm
K- 07 40 39 06	G 3/8	G 3/8	26,5	9,0	22 mm
K- 07 40 39 07	G 3/8	G 1/2	29,5	9,0	24 mm
K- 07 40 39 08	G 1/2	G 1/2	29,5	10,0	25 mm