

K-DRGREDV

Pressure reducing valves

Características

Pressão de entrada	Max. 15 bar
Conexão	G 1/4 internal / external
Material	Latão

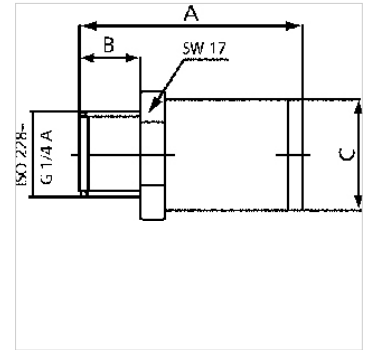
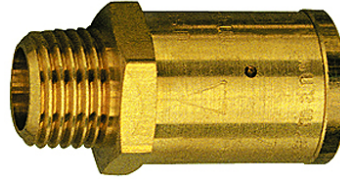

Nota

Dependent on the input pressure P1, the initial pressure P2 can vary between -20% to +20%
Outras indicações a pedido.

Descrição

Industry, trade and repair shops often require working pressures of 15 bar or less. These pressure reducing valves, which are screwed directly onto the tool, enable the actually necessary working pressure to be set.
Benefits: Significantly reduced risk of accidents, Longer tool life with fewer malfunctions, Lower noise levels at the workplace.

Artigo

Descrição	Pressão de ajuste	Fluxo máx. (L/min)	A (mm)	B	Ø C (mm)	SW (mm)
K- 07 25 19 31	2,0	300	34,0	9,0 mm	17,0	17
K- 07 25 02 00	3,0	360	34,0	9,0 mm	17,0	17
K- 07 25 02 01	4,0	380	34,0	9,0 mm	17,0	17
K- 07 25 02 02	5,0	390	34,0	9,0 mm	17,0	17
K- 07 25 02 03	6,0	405	34,0	9,0 mm	17,0	17
K- 07 25 19 32	7,0	415	34,0	9,0 mm	17,0	17
K- 07 25 19 33	8,0	420	34,0	9,0 mm	17,0	17