

K-3/2-BKR MULTIFIX MINI

Ball valves

HANSA FLEX

Características

Temperatura do fluido	max. 60 °C
Temperatura ambiente	Max. 60 °C
Acionamento	Twist knob, rotatable 90°
Fluxo	1800 l/min
Conexão de purga	Silencer G 1/4
Material de vedação	NBR
Carcaça	Die-cast zinc
Medição do valor de fluxo	At P1 = 6 bar and pressure drop $\Delta p = 1$ bar

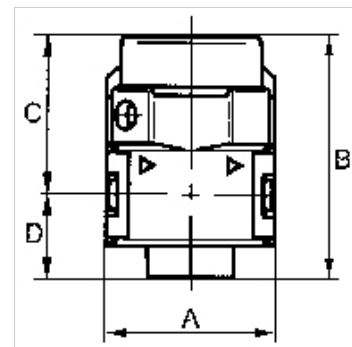
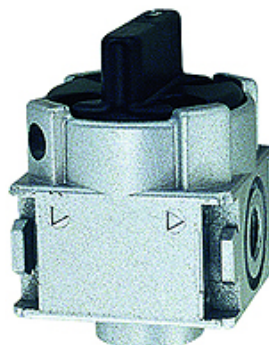

Nota

If several devices in the »multiflex-mini« Series are assembled together, the maximum working pressure is 12 bar.

Outras indicações a pedido.

Descrição

Rotary switch can be turned 90°, lockable, with relief port

Artigo

Descrição	Rosca	A (mm)	B	C (mm)	D (mm)	Tamanho
K- 07 25 11 56	G 1/8	40,0	57,6 mm	37,6	20,0	0
K- 07 25 11 57	G 1/4	40,0	57,6 mm	37,6	20,0	0

Acessório para

K-KOPPELPAKET MEHR	Coupling packet
K-AUTOMAT ABLASSVENTIL	Automatic drain valve
K-SCHALLDAE SINTERBR SCHLITZ	Silencers, sintered bronze, slotted