

K-VT MULTIFIX MINI

Manifold



Características

Pressão de entrada	Max. 16 bar
Temperatura do fluido	max. 60 °C
Temperatura ambiente	Max. 60 °C
Fluxo	P-A = 2700 l/min\nP-B and P-C = 1300 l/min
Material de vedação	NBR
Carcaça	Die-cast zinc
Medição do valor de fluxo	At P1 = 6 bar and pressure drop $\Delta p = 1$ bar

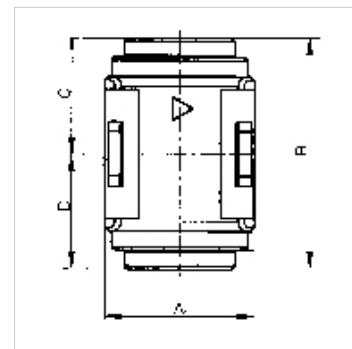
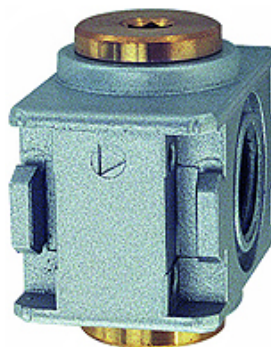

Nota

If several devices in the »multiflex-mini« Series are assembled together, the maximum working pressure is 12 bar.
Outras indicações a pedido.

Descrição

Narrow, two-way manifold with two G 1/8 outlets.

Artigo

Descrição	Rosca	A (mm)	B	C (mm)	D (mm)
K- 07 25 11 81	G 1/4	23,0	36,0 mm	18,0	18,0

Acessório para

K-KOPPELPAKET MEHR Coupling packet