

K-HS RD

Unidirectional banjo valves, pneumatic release, port 2 with female thread

HANSA FLEX

Características

Pressão de trabalho	0.3 - 10 bar
Pressão de controle	0.5 - 2.5 bar, depending on operating pressure
Temperatura do fluido	max. 60 °C
Posição de montagem	Qualquer. Anel deve ser posicionado antes do aperto
Material	Latão niquelado
Material de vedação	Perbunan

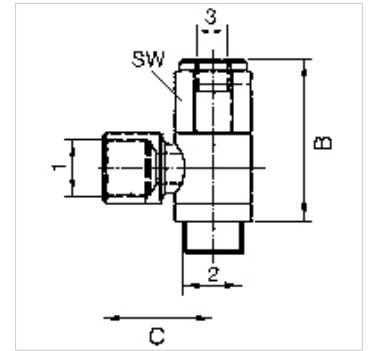

Nota

Outras indicações a pedido.

Descrição

For stopping and positioning the cylinder movement: If a control signal is present at port 3 (see drawing), air can flow to and from the cylinder. If no control signal is present, the cylinder exhaust air is shut off by the unidirectional valve.
The cylinder is stopped. Releasable unidirectional valves are screwed directly onto the cylinder instead of the normal pipe connections.

Artigo

Descrição	Port 1	Port 2	Conexão 3	B (mm)	C (mm)
K- 07 15 07 04	G 1/8	G 1/8	M 5	38,0	21,5
K- 07 15 07 03	G 1/4	G 1/4	G 1/8	43,0	25,4
K- 07 15 07 05	G 3/8	G 3/8	G 1/8	46,0	31,6
K- 07 15 07 02	G 1/2	G 1/2	G 1/8	52,0	32,0