

K-MV G (NC) D 230 V, 50 HZ STA

Normally closed, (NC), directly operated, 230 V, 50 Hz, standard type

HANSA FLEX

Características

Conexão elétrica	device socket type A in acc. with ISO 4400 for all valves with threads G 3/8 & G 1/2, except valves type 3 & 4. Device socket
Tipo de proteção	IP 65
Temperatura do fluido	max. 80 °C when using water or oils; max. 90 °C when using with air
Rosca Descrição	G thread acc. DIN EN ISO 228-1
Carcaça, assento de válvula	Brass
Peças interiores	Stainless steel
Vedação	FPM

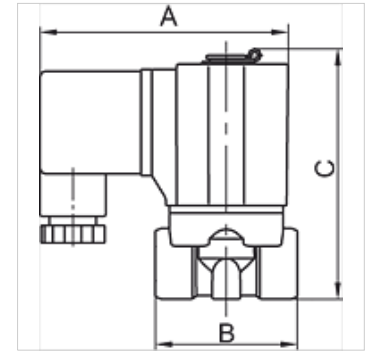

Nota

Outras indicações a pedido.

Descrição

Standard series in two different versions: Directly operated, Pilot-operated. For all applications with compressed air, neutral gases or low-viscosity, neutral media.

Artigo

Descrição	Rosca	Pressão operacional máx. (bar)	NW	A (mm)	B (mm)	C (mm)	Modelo
K- 07 30 01 56	G 1/8	10	3,0	70,0	40,0	70,7	1
K- 07 30 01 57	G 1/4	10	3,0	70,0	40,0	70,7	1
K- 07 30 01 58	G 3/8	10	5,0	85,0	52,0	87,0	1
K- 07 30 01 59	G 1/2	10	5,0	85,0	52,0	87,0	1