

# K-SAUGKOERBE FUER RUECKSCHLAGV

Strainers for check valves

**HANSA FLEX**

## Características

Rosca Descrição	Stainless steel 1.4301
Faixa de temperatura	max. +150 °C
Material de vedação	NBR
Carcaça, malha do filtro	Stainless steel 1.4301

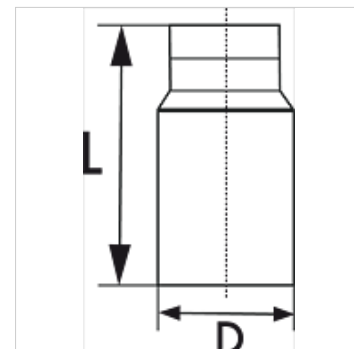
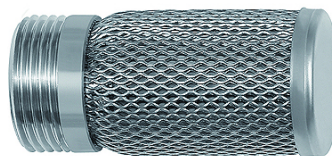

## Descrição

Corrosion resistant screw-in strainer, all stainless steel, to suit foot-operated or check valves.

## Artigo

Descrição	Rosca	D (mm)	L (mm)	Malha metálica (mm)
K- 07 30 30 52	G 3/8	19,0	55,0	1,0
K- 07 30 30 47	G 1/2	22,0	55,0	1,0
K- 07 30 30 51	G 3/4	29,0	62,0	1,0
K- 07 30 30 44	G 1	36,0	71,0	1,0
K- 07 30 30 46	G 1 1/4	43,0	80,0	1,0
K- 07 30 30 45	G 1 1/2	49,0	90,0	1,0
K- 07 30 30 48	G 2	60,0	101,0	1,0
K- 07 30 30 49	G 2 1/2	80,0	111,0	1,8
K- 07 30 30 50	G 3	92,0	125,0	1,8