

K-VLST L AG IG MS NI

Extensions, long, parallel - nickel-plated brass

HANSA FLEX

Características

| | |
|-------------------------|-----------------|
| Temperatura operacional | Max. 150 °C |
| Pressão | Max. 60 bar |
| Material | Latão niquelado |

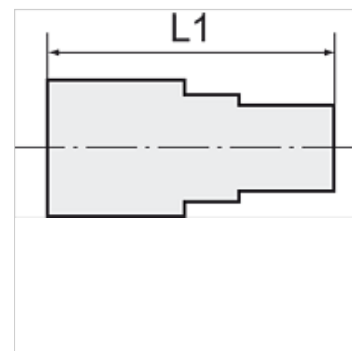

Nota

The dimensions of the standard screw fittings may change slightly during the life of the catalogue as a result of optimisation processes.
Outras indicações a pedido.

Descrição

Suitable for air, water, oil, steam, etc.

Informações adicionais

Further types and dimensions on request.

Artigo

| Descrição | Rosca externa | Rosca interna | L1 (mm) | SW |
|----------------|---------------|---------------|------------|-------|
| K- 07 40 39 16 | G 1/8 | G 1/8 | 22,0 | 14 mm |
| K- 07 40 39 17 | G 1/8 | G 1/8 | 42,0 | 14 mm |
| K- 07 40 39 18 | G 1/8 | G 1/8 | 51,0 | 14 mm |
| K- 07 40 39 19 | G 1/8 | G 1/8 | 100,0 | 14 mm |
| K- 07 40 39 20 | G 1/4 | G 1/4 | 35,0 | 17 mm |
| K- 07 40 39 21 | G 1/4 | G 1/4 | 51,0 | 17 mm |
| K- 07 40 39 22 | G 1/4 | G 1/4 | 100,0 | 17 mm |