

K-BKR GELB STAHLHEBEL IG AG

Ball valves with yellow steel lever, lightweight type, female/male thread

HANSA FLEX

Características

| | |
|--------------------------------|---|
| Campo de aplicação | Ar comprimido, Água, Gases atóxicos e não agressivos, Equipamentos de calefação, Agrícola |
| Pressão operacional | Max. 40 bar |
| Temperatura operacional | -15 °C to +90 °C |
| Rosca Descrição | G thread acc. DIN EN ISO 228-1 |
| Carcaça | Nickel-plated brass |
| Alavanca | Steel, with plastic coating |
| Esfera | Chrome-plated brass |
| Vedação da esfera | PTFE |
| Vedação do fuso | HNBR / EPDM / PTFE. 2 O-Rings (HNBR / EPDM) 1 gasket (PTFE) additional PTFE-gasket |

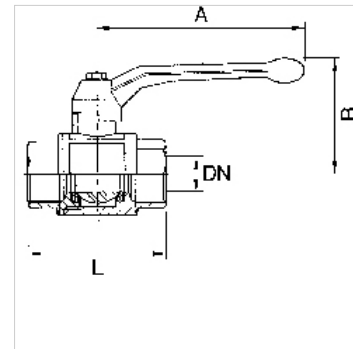
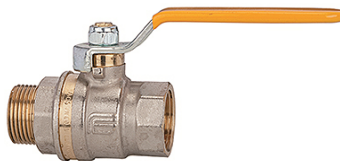

Nota

Outras indicações a pedido.

Artigo

| Descrição | DN | Rosca | A (mm) | B (mm) | L (mm) |
|----------------|----|---------|-----------|-----------|-----------|
| K- 07 30 00 49 | 8 | G 1/4 | 85,0 | 42,0 | 44,0 |
| K- 07 30 00 53 | 10 | G 3/8 | 85,0 | 42,0 | 51,0 |
| K- 07 30 00 57 | 15 | G 1/2 | 85,0 | 46,0 | 60,0 |
| K- 07 30 00 61 | 20 | G 3/4 | 105,0 | 53,0 | 70,0 |
| K- 07 30 00 65 | 25 | G 1 | 105,0 | 57,0 | 79,0 |
| K- 07 30 00 69 | 32 | G 1 1/4 | 130,0 | 70,0 | 91,0 |
| K- 07 30 00 73 | 40 | G 1 1/2 | 130,0 | 76,0 | 104,0 |
| K- 07 30 00 77 | 50 | G 2 | 165,0 | 92,0 | 122,0 |