

# K-SCHL-AUFROLLER SCHWEISS

Hose reel, welding type

**HANSA FLEX**

## Características

<b>Mangueiras</b>	Welding hose for oxygen and acetylene, red and blue, made from synthetic rubber.
<b>Pressão operacional</b>	máx. 10 bar
<b>Fixação</b>	Montagem em parede, piso ou teto
<b>Entrada</b>	Oxygen G 1/4 male, right-hand thread with 60° inside cone, Acetylene G 3/8 male, left-hand thread with 60° inside cone

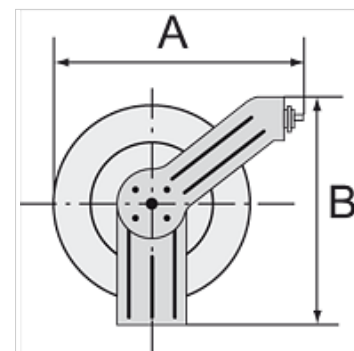

## Nota

Outras indicações a pedido.

## Descrição

Heavy-duty steel design for industrial applications. Blue, powder-coated housing. Special reel guide prevents excessive wear on the hose. An automatic latching mechanism allows the hose to be engaged at any length. Enclosed spring. Precise locking device for continuous feeding or latching mechanism.

## Artigo

Descrição	Dimensão da mangueira	Altura (mm)	Diâmetro (mm)	Comprimento da mangueira (m)
K- 07 10 06 28	Oxygen: 16.5 mm x 6 mm, Acetylene: 17 mm x 10 mm	360	320	15