

K-W TUE VB PP

Union elbows

HANSA FLEX

Características

Pressão de trabalho on request

Temperatura operacional Max. +20 °C

Material Polipropileno (PP)

Material de vedação NBR

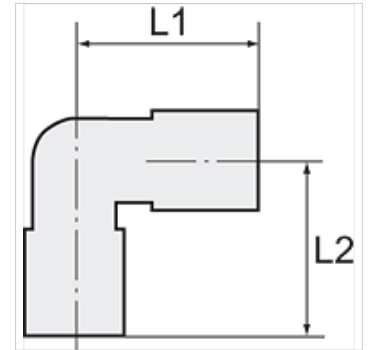

Nota

Outras indicações a pedido.

Descrição

Lightweight, push-in fittings distinguished by high strength, toughness, resistance to abrasion and impact resistance - ideal for a wide range of applications. Plastic and metal tubes are connected together quickly and easily. Suitable for compressed air or liquids, with good resistance to a large number of chemicals.

Artigo

Descrição	para Ø externo da mangueira	L1 (mm)	L2 (mm)	Bocal (mm)
K- 07 40 29 10	32 mm	105,3	96,0	32