

K-SCHLAUCH VB PFA

Hose connectors - Perfluoroalkoxy alkane (PFA)

HANSA FLEX

Características

Pressão operacional	Dependent on operating temperature; Max. 10 bar (at 20 °C); Max. 1 bar (at 170 °C)
Temperatura operacional	Max. 200 °C
Material	Perfluoroalcoxi (PFA)

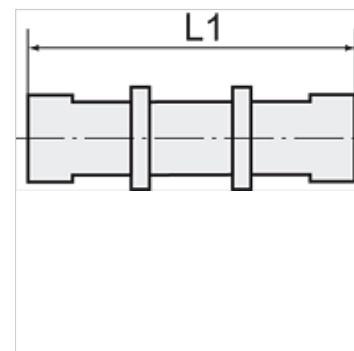
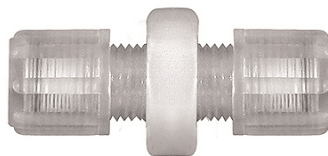

Nota

Outras indicações a pedido.

Descrição

Perfluoroalkoxy alkane (PFA): A fluoroplastic (PTFE) with the same chemical resistance as PTFE but much stronger and suitable for temperatures up to 200°C.

Artigo

Descrição	para mangueira	L1 (mm)	SW
K- 07 40 41 48	4 mm / 6 mm	39,0	14 mm
K- 07 40 41 52	6 mm / 8 mm	49,0	19 mm
K- 07 40 41 54	8 mm / 10 mm	55,0	22 mm
K- 07 40 41 56	9 mm / 12 mm	64,0	24 mm