

# K-ABSPV AG OR

Shut-off valves, double parallel thread with O-ring

**HANSA FLEX**

## Características

<b>Pressão de trabalho</b>	Max. 15 bar, coarse vacuum
<b>Campo de aplicação</b>	Ar, Vácuo
<b>Mangueiras recomendadas</b>	PU or PA (nylon)
<b>Fluidos</b>	Compressed air and all gases or liquids that are compatible with the materials
<b>Faixa de temperatura</b>	-20 °C to +80 °C
<b>Área de vedação</b>	Parallel version: O-ring in housing, Conical version: thread coating
<b>Material</b>	Polímero e latão niquelado
<b>Anel de pressão</b>	Plastic

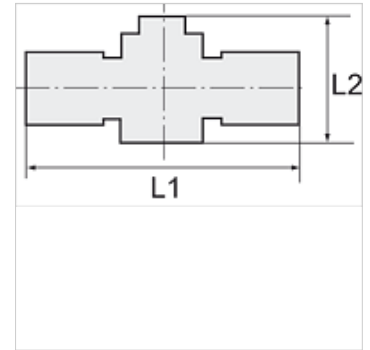

## Nota

Outras indicações a pedido.

## Descrição

Push-in fittings series manufactured in plastic and nickel-plated brass. All parts are suitable for use with hoses, tubes or pipes made of plastic and copper.

## Artigo

Descrição	Rosca 1	Rosca 2	L1 (mm)	L2 (mm)	SW
K- 07 40 08 10	G 1/8	G 1/8	64,5	42,6	14 mm
K- 07 40 08 09	G 1/4	G 1/8	67,6	42,6	17 mm / 14 mm
K- 07 40 08 08	G 1/4	G 1/4	67,6	42,6	17 mm
K- 07 40 08 11	G 3/8	G 1/4	81,1	47,0	20 mm / 20 mm
K- 07 40 08 12	G 3/8	G 3/8	82,4	47,0	20 mm / 20 mm
K- 07 40 08 07	G 1/2	G 3/8	86,2	47,0	24 mm / 21 mm
K- 07 40 08 06	G 1/2	G 1/2	89,0	47,0	24 mm