

K-L-STECK VB VA

Union elbows



Características

Pressão de trabalho pulsante	Max. 10 bar
Pressão	Max. 15 bar (depending on pipe quality)
Material do tubo adequado	PVDF, PTFE, stainless steel, PA, PU
Temperatura ambiente	-20 °C to max. +150 °C (depending on pipe quality and diameter)
Material	Aço inoxidável 1.4404
Material de vedação	FKM

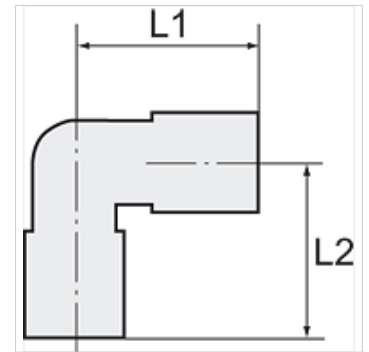

Nota

Outras indicações a pedido.

Descrição

For use with aggressive media and in areas with corrosive outside influences, in the food processing industry and in hygienic and sanitary applications.

Artigo

Descrição	para Ø externo da mangueira	L1 (mm)	L2 (mm)
K- 07 40 24 20	4 mm	17,0	17,0
K- 07 40 24 21	6 mm	20,0	20,0
K- 07 40 24 22	8 mm	21,0	21,0
K- 07 40 24 23	10 mm	25,0	25,0
K- 07 40 24 24	12 mm	27,0	27,0