

K-SCHOTT-STECKVERB 4

Female bulkhead connectors

HANSA FLEX

Características

Pressão de trabalho Max. 16 bar

Temperatura operacional -20 °C to +80 °C

Material Latão niquelado

Anel de pressão Hostaform

Anel tensor Stainless steel

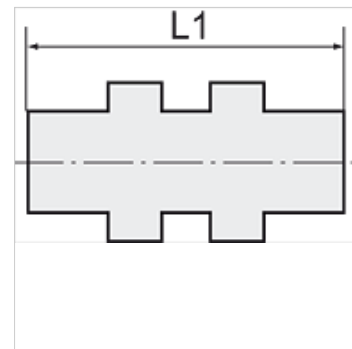
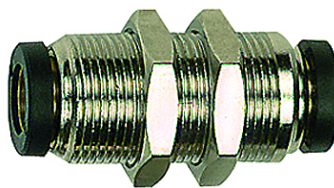

Nota

Outras indicações a pedido.

Descrição

The advanced version of our highly successful push-in fittings series manufactured in nickel-plated brass. Advantages of this new, optimised series: Much easier connection and disconnection of the hose, even with repeated mounting, can also be used for non-calibrated hoses, suitable for vacuum operation.

Artigo

| Descrição | Rosca | para Ø externo da mangueira | L1 (mm) | SW |
|----------------|------------|-----------------------------|------------|-------|
| K- 07 40 47 16 | M 8 x 0.75 | 3 mm | 18,4 | 10 mm |
| K- 07 40 25 50 | M 11 x 1 | 4 mm | 30,6 | 13 mm |
| K- 07 40 25 52 | M 14 x 1 | 5 mm | 33,5 | 17 mm |
| K- 07 40 25 53 | M 13 x 1 | 6 mm | 33,0 | 16 mm |
| K- 07 40 25 56 | M 15 x 1 | 8 mm | 35,7 | 17 mm |
| K- 07 40 25 59 | M 17 x 1 | 10 mm | 39,2 | 20 mm |
| K- 07 40 25 60 | M 20 x 1 | 12 mm | 40,7 | 24 mm |
| K- 07 40 25 61 | M 24 x 1 | 14 mm | 45,9 | 27 mm |