

# K-ABSPV STECK GEW SCH OR

Shut-off valves, male thread, plug connection, flow direction to tube, parallel thread with O-ring

**HANSA FLEX**

## Características

<b>Pressão de trabalho</b>	Max. 15 bar, coarse vacuum
<b>Campo de aplicação</b>	Ar, Vácuo
<b>Mangueiras recomendadas</b>	PU or PA (nylon)
<b>Fluidos</b>	Compressed air and all gases or liquids that are compatible with the materials
<b>Faixa de temperatura</b>	-20 °C to +80 °C
<b>Área de vedação</b>	Parallel version: O-ring in housing, Conical version: thread coating
<b>Material</b>	Polímero e latão niquelado
<b>Anel de pressão</b>	Plastic

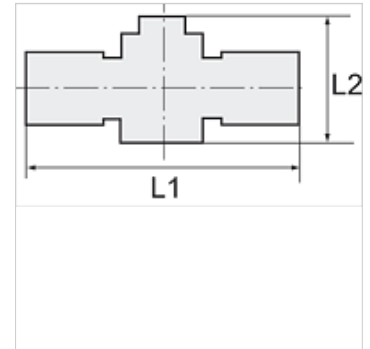
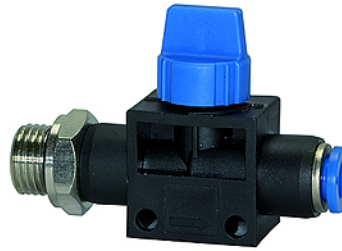

## Nota

Outras indicações a pedido.

## Descrição

Push-in fittings series manufactured in plastic and nickel-plated brass. All parts are suitable for use with hoses, tubes or pipes made of plastic and copper.

## Artigo

Descrição	Rosca	para Ø externo da mangueira	L1 (mm)	L2 (mm)	SW
K- 07 40 08 01	G 1/8	6 mm	58,0	42,6	14 mm
K- 07 40 08 02	G 1/8	8 mm	58,4	42,6	14 mm
K- 07 40 07 99	G 1/4	6 mm	59,8	42,6	12 mm
K- 07 40 08 00	G 1/4	8 mm	59,9	42,6	17 mm
K- 07 40 07 97	G 1/4	10 mm	70,9	47,0	17 mm
K- 07 40 07 98	G 1/4	12 mm	70,9	47,0	21 mm
K- 07 40 08 05	G 3/8	8 mm	61,4	42,6	17 mm
K- 07 40 08 03	G 3/8	10 mm	72,4	47,0	20 mm
K- 07 40 08 04	G 3/8	12 mm	71,9	47,0	21 mm
K- 07 40 07 95	G 1/2	10 mm	75,9	47,0	24 mm
K- 07 40 07 96	G 1/2	12 mm	75,4	47,0	24 mm