

# K-L-STECK VB

## Union elbows



### Características

Pressão de trabalho	Max. 16 bar
Temperatura operacional	-20 °C to +150 °C
Material	Latão niquelado
Anel de pressão	Nickel-plated brass
Anel tensor	Stainless steel

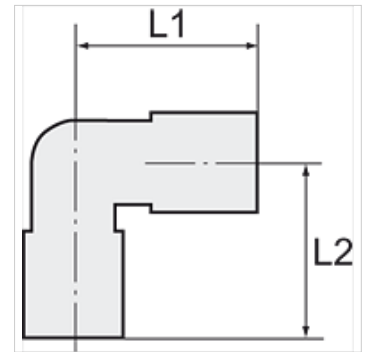

### Nota

Outras indicações a pedido.

### Descrição

Push-in fittings, manufactured entirely in nickel-plated brass. All parts with a parallel thread are supplied with an FPM O-ring. All parts with conical threads are coated with preCOTE 5 dispersion, all fittings in this series can thus also be used at high temperatures (medium compressed air).

### Artigo

Descrição	para Ø externo da mangueira	L1 (mm)	L2 (mm)
K- 07 40 27 53	4 mm	17,5	17,5
K- 07 40 27 54	6 mm	20,0	20,0
K- 07 40 27 55	8 mm	23,0	23,0
K- 07 40 27 56	10 mm	25,0	25,0
K- 07 40 47 79	12 mm	27,5	27,5
K- 07 40 47 80	14 mm	31,0	31,0