

Características

Pressão operacional	60 bar
Temperatura operacional	Max. 150 °C
Rosca interna	Parallel to DIN EN ISO 228-1
Material	Latão niquelado
Rosca externa	conical acc. DIN 2999

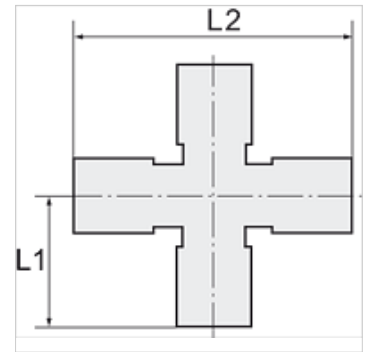
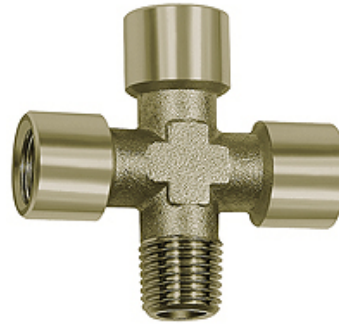

Nota

Outras indicações a pedido.

Artigo

Descrição	Rosca	L1 (mm)	L2 (mm)	SW
K- 07 40 49 11	G/R 1/8	18,5	42,0	10 mm
K- 07 40 49 12	G/R 1/4	23,5	51,0	13 mm
K- 07 40 49 13	G/R 3/8	26,0	56,0	17 mm
K- 07 40 49 14	G/R 1/2	31,0	67,0	21 mm