

Caracteristici

Racord 1	Filete NPT exterioare
Formă de etanșare 1	cu etanșare pe filet
Racord 2	Filet metric exterior cilindric
Formă de etanșare 2	Con interior 24°
Tip constructiv	Racord filetat tip tată
Forma constructivă	Racord 90°
Standard	DIN 2353 ISO 8434-1
Set de livrare	Ștuț (fără piuliță olandeză și inel de tăiere)
Material	Oțel
Protecția suprafeței	acoperire galvanică

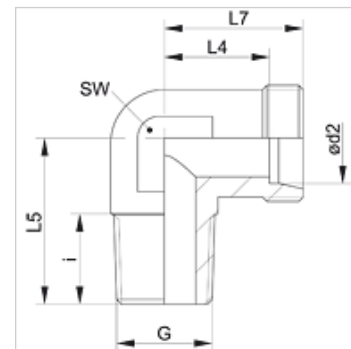

Indicație

Indicațiile privind montajul, asamblarea, încărcarea cu presiune și temperaturile de regim admisibile se găsesc în informațiile tehnice referitoare la îmbinările filetate pentru țevi.

Articol

Denumire	Seria	Presiune de lucru bar	Ø exterior țevă (mm)	G	i (mm)	L4 (mm)	L5 (mm)	L7 (mm)	SW (mm)
XWN 04 LL	LL	PN 100	4	1/8" -27 NPT	8,0	11,0	17	15,0	9
XWN 05 LL	LL	PN 100	5	1/8" -27 NPT	8,0	11,0	17	15,0	9
XWN 06 LL	LL	PN 100	6	1/8" -27 NPT	8,0	9,5	17	15,0	9
XWN 08 LL	LL	PN 100	8	1/8" -27 NPT	10,0	11,5	20	17,0	12
XWN NW 04 HL	L	PN 315	6	1/8" -27 NPT	10,0	12,0	20	19,0	12
XWN NW 04 HL 1/4	L	PN 315	6	1/4" -18 NPT	12,0	14,0	26	21,0	12
XWN NW 04 HL 1/2	L	PN 315	6	1/2" -14 NPT	17,0	23,0	34	30,0	19
XWN NW 06 HL	L	PN 315	8	1/4" -18 NPT	12,0	14,0	26	21,0	12
XWN NW 06 HL 3/8	L	PN 315	8	3/8" -18 NPT	15,2	15,5	20	18,5	12
XWN NW 06 HL 1/2	L	PN 315	8	1/2" -14 NPT	17,5	15,0	26	22,0	12
XWN NW 08 HL	L	PN 315	10	1/4" -18 NPT	14,0	15,0	27	22,0	14
XWN NW 08 HL 3/8	L	PN 315	10	3/8" -18 NPT	15,2	15,0	27	22,0	14
XWN NW 10 HL	L	PN 315	12	3/8" -18 NPT	12,5	17,0	28	24,0	17
XWN NW 10 HL 1/4	L	PN 315	12	1/4" -18 NPT	14,0	17,0	28	24,0	17
XWN NW 10 HL 1/2	L	PN 315	12	1/2" -14 NPT	19,0	23,0	34	30,0	19
XWN NW 13 HL	L	PN 315	15	1/2" -14 NPT	18,5	21,0	34	28,0	19
XWN NW 13 HL 3/8	L	PN 315	15	3/8" -18 NPT	13,0	21,0	34	28,0	19
XWN NW 16 HL	L	PN 315	18	1/2" -14 NPT	20,0	23,5	36	31,0	24
XWN NW 16 HL 3/4	L	PN 315	18	3/4" -14 NPT	18,5	23,5	40	31,0	24
XWN NW 20 HL	L	PN 160	22	3/4" -14 NPT	18,5	27,5	42	35,0	27
XWN NW 25 HL	L	PN 160	28	1" -11,5 NPT	24,0	30,5	48	38,0	36
XWN NW 32 HL	L	PN 160	35	1.1/4" -11,5 NPT	25,5	34,5	54	45,0	41
XWN NW 40 HL	L	PN 160	42	1.1/2" -11,5 NPT	26,0	40,0	61	51,0	50
XWN NW 03 HS	S	PN 630	6	1/4" -18 NPT	12,0	16,0	26	23,0	12
XWN NW 04 HS	S	PN 630	8	1/4" -18 NPT	15,0	17,0	27	24,0	14
XWN NW 06 HS	S	PN 630	10	3/8" -18 NPT	12,0	17,5	28	25,0	17
XWN NW 08 HS	S	PN 630	12	3/8" -18 NPT	12,5	21,5	28	29,0	17
XWN NW 10 HS	S	PN 630	14	1/2" -14 NPT	18,0	22,0	34	30,0	19
XWN NW 13 HS	S	PN 400	16	1/2" -14 NPT	19,0	24,5	36	33,0	24
XWN NW 13 HS 3/4	S	PN 400	16	3/4" -14 NPT	20,0	24,5	40	33,0	24
XWN NW 16 HS	S	PN 400	20	3/4" -14 NPT	20,0	26,6	42	37,0	27
XWN NW 20 HS	S	PN 400	25	1" -11,5 NPT	24,0	30,0	48	42,0	36
XWN NW 25 HS	S	PN 400	30	1.1/4" -11,5 NPT	25,5	35,5	54	49,0	41
XWN NW 32 HS	S	PN 315	38	1.1/2" -11,5 NPT	26,0	41,0	61	57,0	50

Seria: LL = foarte ușoară L = ușoară S = grea - PN = Presiunea nominală PB = Presiunea max. de lucru - Ø d2 = diametru exterior țevă

Variante produs

XWN VA	Racord filetat tip tată, 90°, oțel inoxidabil
WN	Racord filetat tip tată, 90°, Oțel