

XWRK VA

Racord filetat tip tată, 90°

Caracteristici

Racord 1	Filete conice exterioare BSPT
Formă de etanșare 1	cu etanșare pe filet
Racord 2	Filet metric exterior cilindric
Formă de etanșare 2	Con interior 24°
Tip constructiv	Racord filetat tip tată
Forma constructivă	Racord 90°
Standard	DIN 3903
Set de livrare	Ștuț (fără piuliță olandeză și inel de tăiere)
Material	oțel inoxidabil

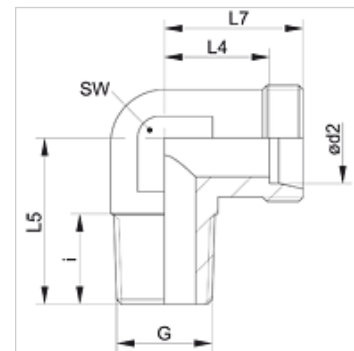

Indicație

Indicațiile privind montajul, asamblarea, încărcarea cu presiune și temperaturile de regim admisibile se găsesc în informațiile tehnice referitoare la îmbinările filetate pentru țevi.

Articol

Denumire	Seria	Presiune de lucru bar	Ø d2 (mm)	G	i (mm)	L4 (mm)	L5 (mm)	L7 (mm)	SW (mm)
XWR 04 LL VA	LL	PN 100	4	R 1/8" K	8	11,0	17,0	15,0	9
XWR 06 LL VA	LL	PN 100	6	R 1/8" K	8	9,5	17,0	15,0	9
XWR 08 LL VA	LL	PN 100	8	R 1/8" K	8	11,5	20,0	17,0	12
XWR NW 04 HL VA	L	PN 315	6	R 1/8" K	8	12,0	20,0	19,0	12
XWR NW 04 HL 1/2 VA	L	PN 315	6	R 1/2" K	14	15,5	30,0	22,5	17
XWR NW 04 HL 1/4 VA	L	PN 315	6	R 1/4" K	12	14,0	26,0	21,0	12
XWR NW 04 HL 3/8 VA	L	PN 315	6	R 3/8" K	12	17,0	28,0	24,0	17
XWR NW 06 HL VA	L	PN 315	8	R 1/4" K	12	14,0	26,0	21,0	12
XWR NW 06 HL 1/8 VA	L	PN 315	8	R 1/8" K	8	14,0	26,0	21,0	12
XWR NW 06 HL 3/8 VA	L	PN 315	8	R 3/8" K	12	19,0	28,0	26,0	17
XWR NW 06 HL 1/2 VA	L	PN 315	8	R 1/2" K	13	20,0	34,0	27,0	19
XWR NW 08 HL VA	L	PN 315	10	R 1/4" K	12	15,0	27,0	22,0	14
XWR NW 08 HL 1/8 VA	L	PN 315	10	R 1/8" K	8	15,0	27,0	22,0	14
XWR NW 08 HL 3/8 VA	L	PN 315	10	R 3/8" K	12	17,0	28,0	24,0	17
XWR NW 08 HL 1/2 VA	L	PN 316	10	R 1/2" K	14	23,0	34,0	30,0	19
XWR NW 10 HL 1/8 VA	L	PN 315	12	R 1/8" K	8	17,0	27,0	24,0	17
XWR NW 10 HL 1/4 VA	L	PN 315	12	R 1/4" K	12	17,0	28,0	24,0	17
XWR NW 10 HL VA	L	PN 315	12	R 3/8" K	12	17,0	28,0	24,0	17
XWR NW 10 HL 1/2 VA	L	PN 315	12	R 1/2" K	14	23,0	34,0	30,0	19
XWR NW 13 HL VA	L	PN 315	15	R 1/2" K	14	21,0	34,0	28,0	19
XWR NW 13 HL 1/4 VA	L	PN 315	15	R 1/4" K	12	21,0	34,0	28,0	19
XWR NW 13 HL 3/8 VA	L	PN 315	15	R 3/8" K	12	21,0	34,0	28,0	19
XWR NW 13 HL 3/4 VA	L	PN 160	15	R 3/4" K	16	21,0	24,0	28,0	24
XWR NW 16 HL VA	L	PN 315	18	R 1/2" K	14	23,5	36,0	31,0	24
XWR NW 16 HL 3/8 VA	L	PN 315	18	R 3/8" K	12	23,5	36,0	31,0	24
XWR NW 16 HL 3/4 VA	L	PN 315	18	R 3/4" K	16	27,5	42,0	35,0	27
XWR NW 20 HL 1/2 VA	L	PN 160	22	R 1/2" K	14	27,5	41,0	35,0	27
XWRK NW 20 HL VA	L	PN 160	22	R 3/4" K	16	27,5	42,0	35,0	27
XWRK NW 25 HL VA	L	PN 160	28	R 1" K	20	30,5	47,0	38,0	36
XWR NW 03 HS VA	S	PN 400	6	R 1/4" K	12	16,0	26,0	23,0	12
XWR NW 03 HS 1/8 VA	S	PN 400	6	R 1/8" K	8	15,0	25,0	22,0	12
XWR NW 03 HS 3/8 VA	S	PN 400	6	R 3/8" K	12	17,5	27,0	24,5	14
XWR NW 03 HS 1/2 VA	S	PN 400	6	R 1/2" K	14	19,0	33,0	26,0	17
XWR NW 04 HS VA	S	PN 400	8	R 1/4" K	12	17,0	27,0	24,0	14
XWR NW 04 HS 3/8 VA	S	PN 400	8	R 3/8" K	12	18,0	28,0	25,0	14
XWR NW 04 HS 1/2 VA	S	PN 400	8	R 1/2" K	14	23,0	33,0	30,0	17
XWR NW 06 HS VA	S	PN 400	10	R 3/8" K	12	17,5	28,0	25,0	17
XWR NW 06 HS 1/4 VA	S	PN 400	10	R 1/4" K	12	17,5	28,0	25,0	17
XWR NW 06 HS 1/2 VA	S	PN 400	10	R 1/2" K	14	22,5	32,0	30,0	17
XWR NW 08 HS VA	S	PN 400	12	R 3/8" K	12	21,5	28,0	29,0	17
XWR NW 08 HS 1/4 VA	S	PN 400	12	R 1/4" K	12	21,5	27,0	29,0	17
XWR NW 08 HS 1/2 VA	S	PN 400	12	R 1/2" K	14	23,5	34,0	31,0	19



XWRK VA

Racord filetat tip tată, 90°

HANSA FLEX

Articol

Denumire	Seria	Presiune de lucru bar	Ø d2 (mm)	G	i (mm)	L4 (mm)	L5 (mm)	L7 (mm)	SW (mm)
XWR NW 10 HS VA	S	PN 400	14	R 1/2" K	14	22,0	32,0	30,0	19
XWR NW 10 HS 3/8 VA	S	PN 400	14	R 3/8" K	12	22,0	30,0	30,0	19
XWR NW 13 HS VA	S	PN 400	16	R 1/2" K	14	24,5	32,0	33,0	24
XWR NW 13 HS 3/8 VA	S	PN 400	16	R 3/8" K	12	24,5	32,0	33,0	24
XWR NW 13 HS 3/4 VA	S	PN 160	16	R 3/4" K	16	24,5	41,0	33,0	24
XWR NW 16 HS 1/2 VA	S	PN 400	20	R 1/2" K	14	26,5	42,0	37,0	27
XWRK NW 16 HS VA	S	PN 160	20	R 3/4" K	16	26,5	42,0	37,0	27

Seria: LL = foarte ușoară L = ușoară S = grea - PN = Presiunea nominală PB = Presiunea max. de lucru - Ø d2 = diametru exterior țevă

Variante produs

XWRK	Racord filetat tip tată, 90°, Oțel
WRK VA	Racord filetat tip tată, 90°, oțel inoxidabil