

K-DRUCKSCHALTER VAKUUM

Combined vacuum/pressure switch

HANSA FLEX

Caracteristici

Tip constructiv	PNP
Racord de mediu măsurat	G 1/8 male and M 5 female
Histerează	Adjustable: 3 to 25% of set value
Domeniu de temperaturi	0 - 50 °C
Medii	Non-aggressive gases. dry, oil-free air
Carcasă	Polycarbonate
Semnal de ieşire	Analogue: 1 to 5 V
Conexiune electrică	Male connector M8, four pin
Capacitate de întrerupere	125 mA
Consum de curent	30 mA
Afişaj de stare	LED

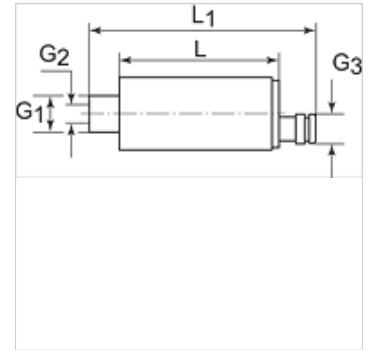
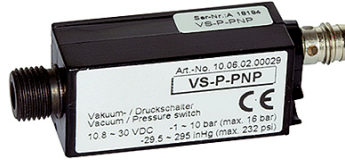

Indicație

Alte date sunt disponibile la cerere.

Descriere

Universal electronic vacuum and pressure switch for safety monitoring, optimisation of cycle times and regulation circuits. Its small size and low weight permit installation directly at the point of use. Suitable for all special applications in the vacuum and compressed air sectors. Adjustable vacuum limit value and continuous vacuum monitoring.

Articol

Denumire	Filet 1 exterior	Filet 2 interior	Filet 3 exterior	L (mm)	L1 (mm)	Domeniu de măsurare	Tensiune
K- 07 45 01 31	G 1/8	M 5	M 8 x 1	44,0	62,0	-1 bis +10 bar	10.8 - 30 V DC