

K-DRS ELK GERAETESTECKER

Pressure switches, connection with plug connector, type A acc. to DIN 43650

HANSA FLEX

Caracteristici

Domeniul de utilizare	Pneumatic applications
Frecvența comutării	200/min.
Tensiune de comutare	max. 250 V AC / 28 V DC
Tip de protecție	IP 65 (DIN 43650), IP 67 (M 12 x 1)
Domeniu de temperaturi	-10 °C to +80 °C
Capac de reglare	Aluminium, powder-coated
Carcasă	Special die-cast material
Membrană, garnitură	NBR

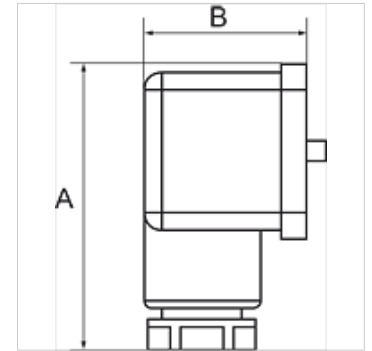

Indicație

Alte date sunt disponibile la cerere.

Descriere

For converting pneumatic to electrical signals. Designed for use in rough vacuum applications (technical vacuum). Universal switch type, suitable as NC, NO or changeover contact. These devices are free from paint-wetting impairment substances (PWIS).

Articol

Denumire	Racord	Domeniu de reglare	A (mm)	B (mm)
K- 07 30 28 45	G 1/4	0,2 - 2,0 bar	48,0	28,0
K- 07 30 28 46	G 1/4	0,5 - 8,0 bar	48,0	28,0
K- 07 30 28 47	G 1/4	1,0 - 16,0 bar	48,0	28,0