

# K-DRS ELK ANSCHLUSS M VAKUUM

Pressure switches, electrical connection M 12 x 1

**HANSA FLEX**

## Caracteristici

<b>Domeniul de utilizare</b>	Pneumatic applications
<b>Frecvența comutării</b>	200/min.
<b>Tensiune de comutare</b>	max. 250 V AC / 28 V DC
<b>Domeniu de reglare</b>	-0.85 / +1 bar
<b>Tip de protecție</b>	IP 65 (DIN 43650), IP 67 (M 12 x 1)
<b>Domeniu de temperaturi</b>	-10 °C to +80 °C
<b>Capac de reglare</b>	Aluminium, powder-coated
<b>Carcasă</b>	Special die-cast material
<b>Membrană, garnitură</b>	Perbunan

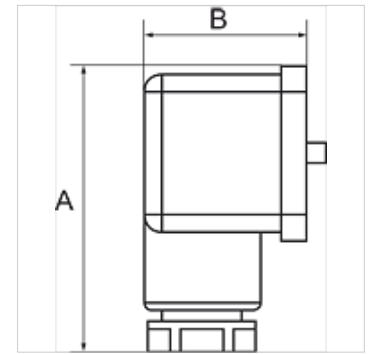

## Indicație

Alte date sunt disponibile la cerere.

## Descriere

For converting pneumatic to electrical signals. Designed for use in rough vacuum applications (technical vacuum). Universal switch type, suitable as NC, NO or changeover contact. These devices are free from paint-wetting impairment substances (PWIS).

## Articol

Denumire	Racord	A (mm)	B (mm)
K- 07 30 28 52	Flanșă	48,0	28,0
K- 07 30 28 54	G 1/4	48,0	28,0