

K-ABBLV VA 1

Stainless steel blow-off safety valves, G 1/8

HANSA FLEX

Caracteristici

Presiune de lucru	0.5 - 60 bar
Temperatura de lucru	max. 180 °C
Garnituri	FKM
Arc	Stainless steel 1.4310
Carcasă	Stainless steel 1.4305

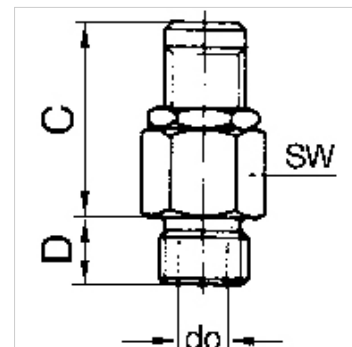

Indicație

G thread acc. to DIN EN ISO 228-1, with ISO flange plate (acc. to ISO 5211)

Alte date sunt disponibile la cerere.

Descriere

Manual adjustment of the blow-off pressure (lock nut).

Indicații referitoare comandă

For use on devices that have to be vented whenever they are turned off, either because of safety regulations or for technical reasons. The pneumatic devices are disconnected from the system and simultaneously vented each time they are shut off.

Informații suplimentare

These blow-off valves can also be supplied with a fixed setting and a TÜV type test number. Please ask for an offer.

Articol

Denumire	Filet	Presiunea de acționare	Putere de purjare	C (mm)	D (mm)	do (mm)	SW (mm)
K- 07 30 21 75	G 1/8	0.5 - 1.0 bar	to 50 l/min	27,0	7,0	3,0	16
K- 07 30 21 76	G 1/8	1.0 - 4.0 bar	to 200 l/min	27,0	7,0	3,0	16
K- 07 30 21 77	G 1/8	3.0 - 7.0 bar	to 350 l/min	27,0	7,0	3,0	16
K- 07 30 21 78	G 1/8	6.0 - 12.0 bar	to 650 l/min	27,0	7,0	3,0	16
K- 07 30 21 79	G 1/8	10.0 - 18.0 bar	to 870 l/min	27,0	7,0	3,0	16
K- 07 30 21 80	G 1/8	16.0 - 32.0 bar	to 1600 l/min	27,0	7,0	3,0	16
K- 07 30 21 81	G 1/8	30.0 - 60.0 bar	to 3000 l/min	27,0	7,0	3,0	16