

# K-XV 6-KANT

Double nipples, hexagonal

**HANSA FLEX**

## Caracteristici

|                   |                              |
|-------------------|------------------------------|
| Presiune de lucru | Max. 20 bar                  |
| Filet exterior    | Parallel to DIN EN ISO 228-1 |
| Material          | Stainless steel 1.4408       |

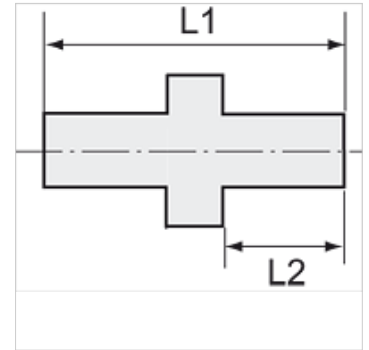
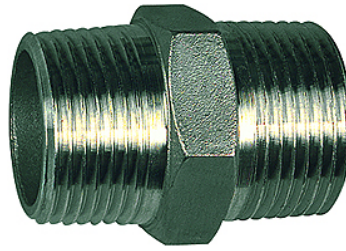

## Indicație

The dimensions of the standard screw fittings may change slightly during the life of the catalogue as a result of optimisation processes. Alte date sunt disponibile la cerere.

## Articol

| Denumire       | Filet   | L1<br>(mm) | L2<br>(mm) | Deschiderea cheii fixe |
|----------------|---------|------------|------------|------------------------|
| K- 07 40 12 18 | G 1/8   | 30,0       | 12,0       | 13 mm                  |
| K- 07 40 12 19 | G 1/4   | 32,0       | 13,0       | 16 mm                  |
| K- 07 40 12 20 | G 3/8   | 34,0       | 13,0       | 20 mm                  |
| K- 07 40 12 21 | G 1/2   | 37,5       | 15,0       | 24 mm                  |
| K- 07 40 12 22 | G 3/4   | 46,0       | 18,0       | 29 mm                  |
| K- 07 40 12 23 | G 1     | 51,0       | 19,0       | 35 mm                  |
| K- 07 40 12 24 | G 1 1/4 | 57,0       | 22,0       | 46 mm                  |
| K- 07 40 12 25 | G 1 1/2 | 58,0       | 23,0       | 51 mm                  |
| K- 07 40 12 26 | G 2     | 66,9       | 26,0       | 63 mm                  |