

K-W90 GAM 2

Female elbows

HANSA FLEX

Caracteristici

Presiune de lucru Max. 18 bar

Material de etanșare Buna-N

Material Alamă nichelată

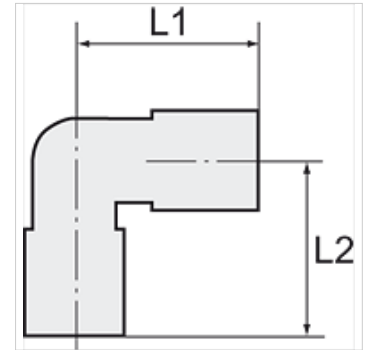

Indicație

Alte date sunt disponibile la cerere.

Articol

Denumire	Filet	pentru furtun	L1 (mm)	L2 (mm)	Deschiderea cheii fixe
K- 07 40 31 71	G 1/8	5 mm / 3 mm	21,5	19,0	10 mm
K- 07 40 31 72	G 1/8	6 mm / 4 mm	22,5	19,0	10 mm
K- 07 40 31 73	G 1/8	8 mm / 6 mm	22,5	19,0	10 mm
K- 07 40 31 69	G 1/4	6 mm / 4 mm	25,0	23,0	11 mm
K- 07 40 31 70	G 1/4	8 mm / 6 mm	25,0	23,0	11 mm
K- 07 40 31 68	G 1/4	10 mm / 8 mm	26,0	23,5	13 mm
K- 07 40 31 74	G 3/8	12 mm / 10 mm	30,5	28,0	17 mm